





 **bar**

0,5  max. 10 

 5  1 

 °C

 max. 90°C   65°C

**11.1**

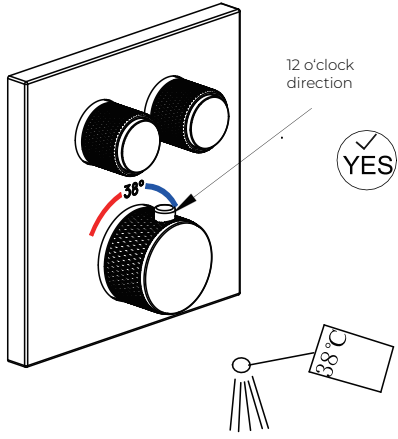

12 o'clock direction

38°C

YES

The rotate thermostatic handle, using thermometer to measure water release temperature. As water temperature knob point to 38 °C, the water temperature should be 38 °C. If water temperature is 38 °C but the knob is not pointing at 38 °C indicator, please follow 11.2 instruction to reinstall the rotate thermostatic handle. (Make use handle knob point at 38 °C). Not pointing at 12 o'clock direction 12 o'clock direction.

**11.2**

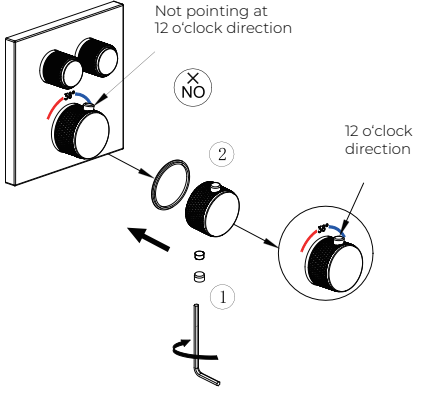

Not pointing at 12 o'clock direction

NO

12 o'clock direction

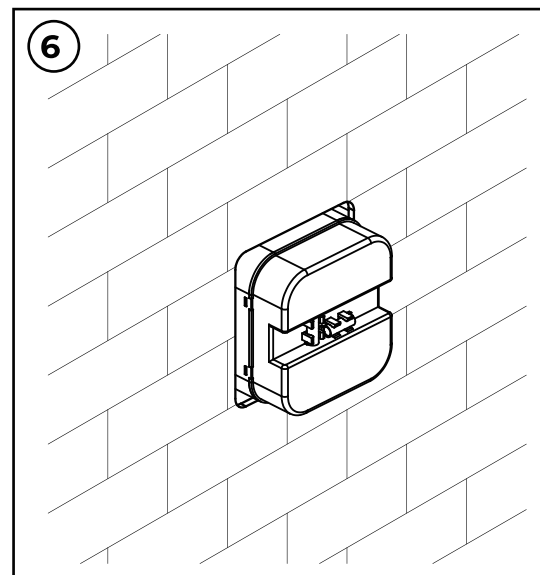
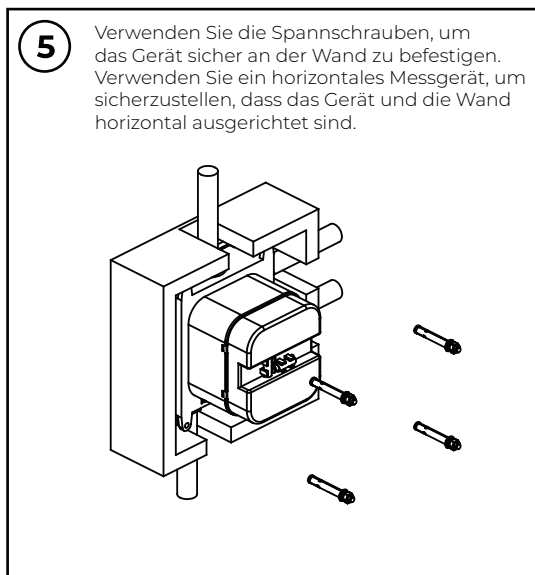
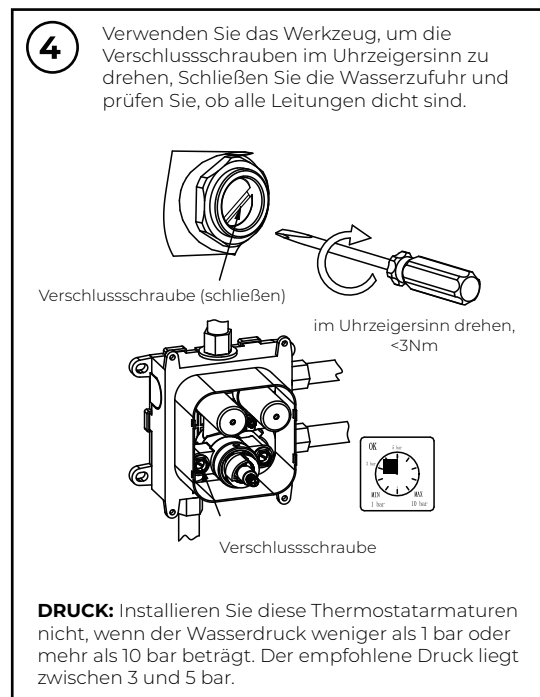
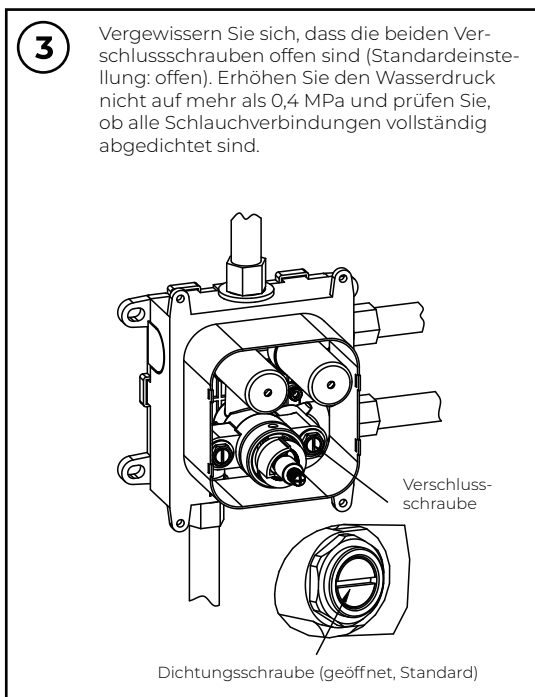
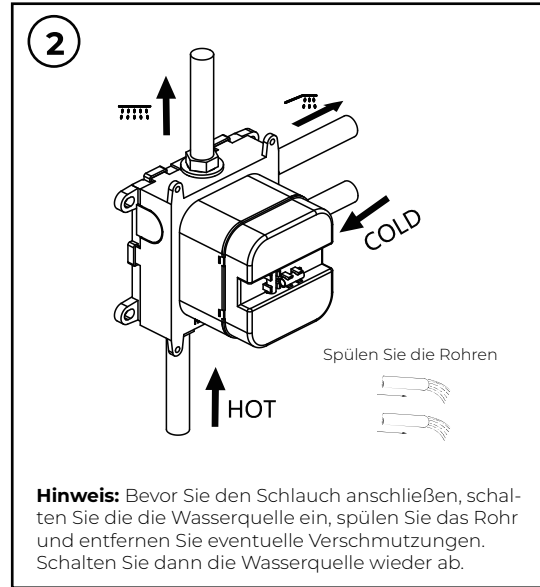
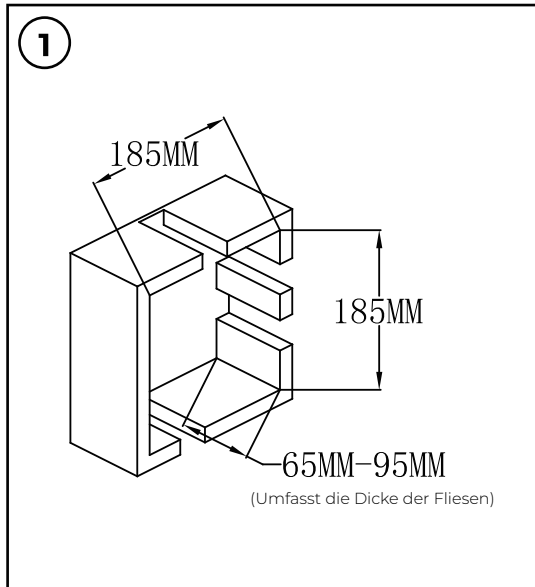

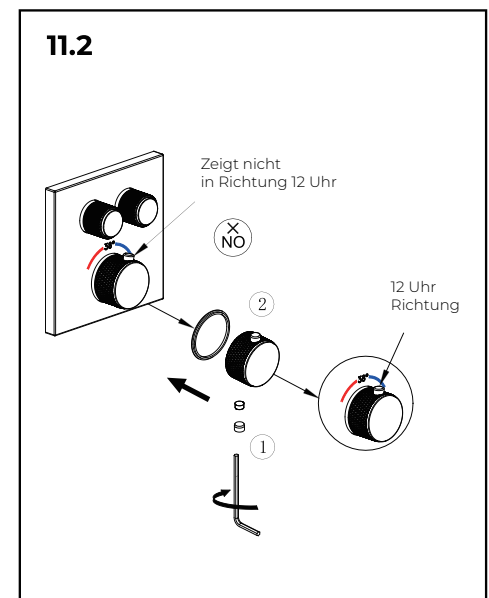
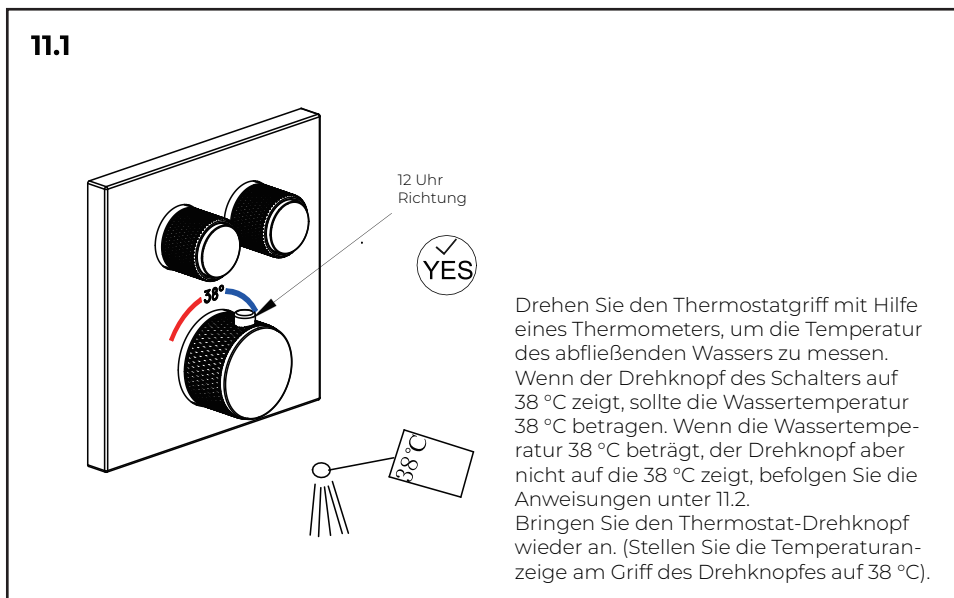
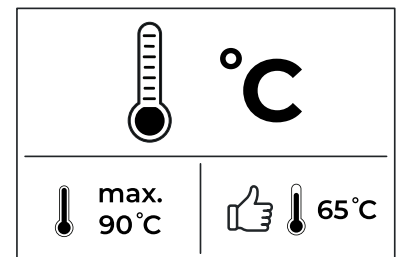
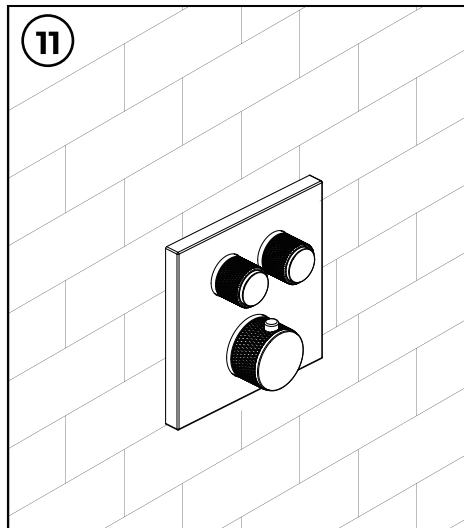
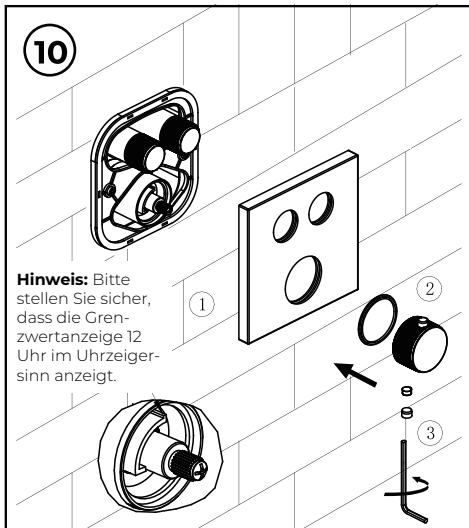
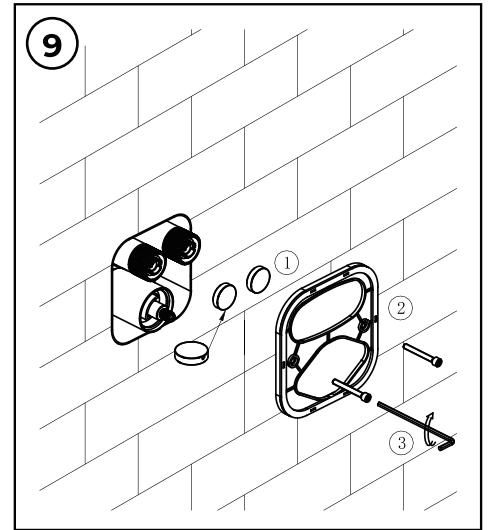
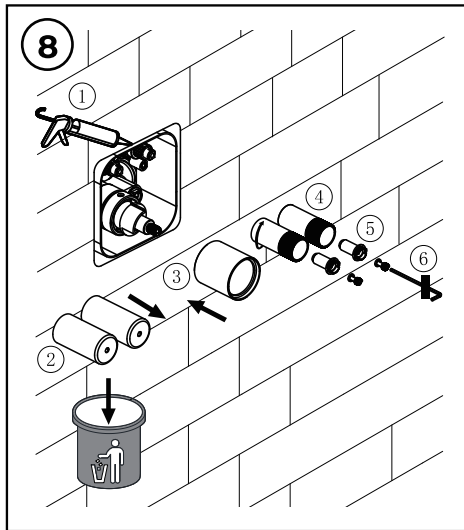
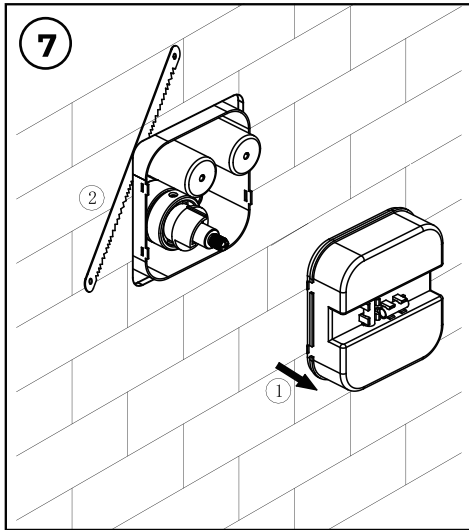

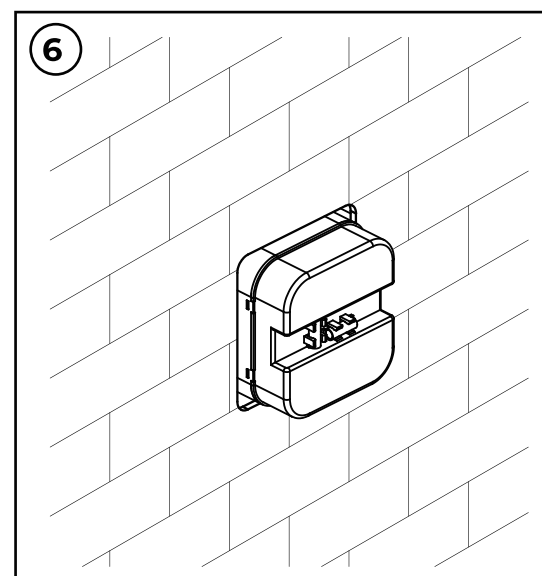
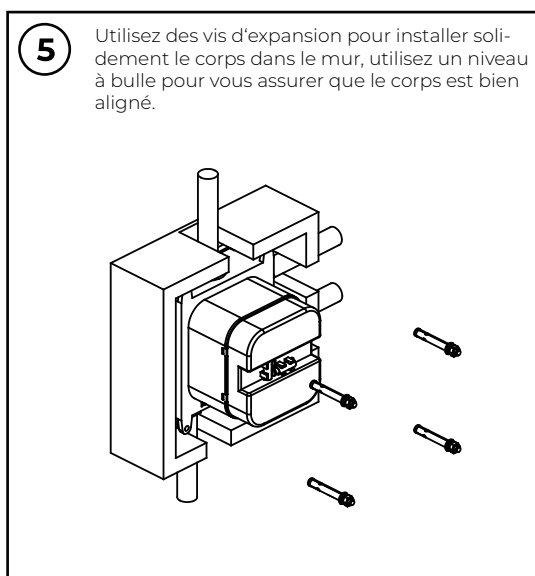
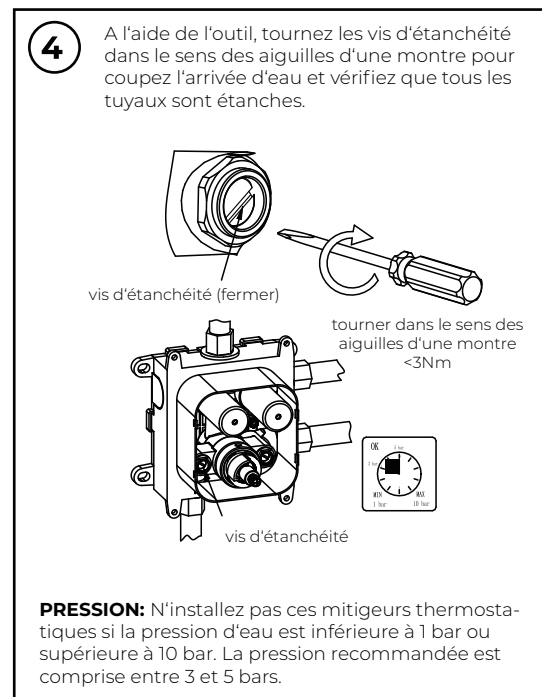
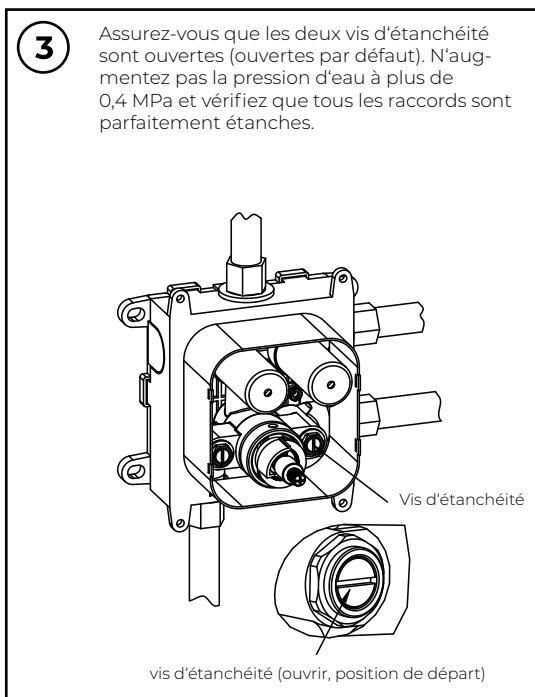
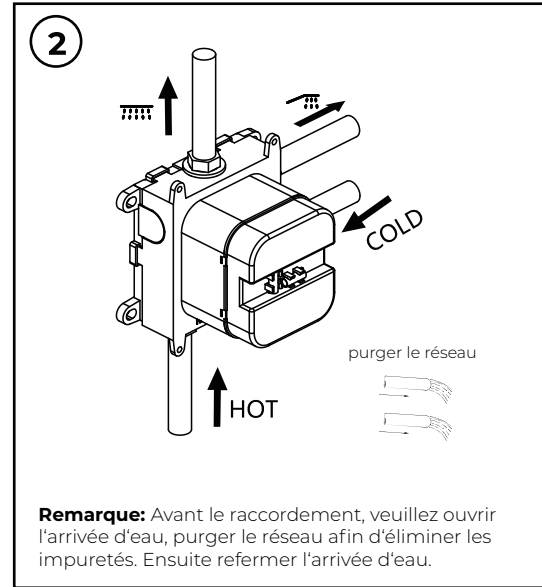
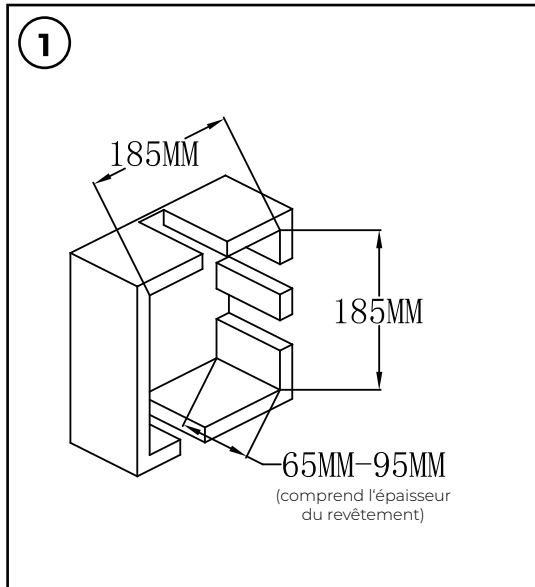

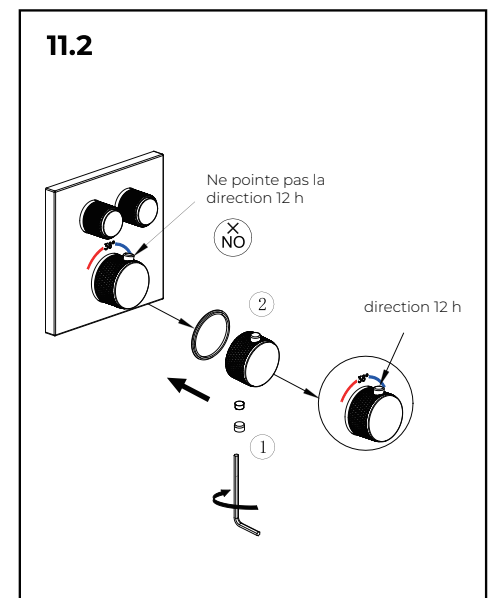
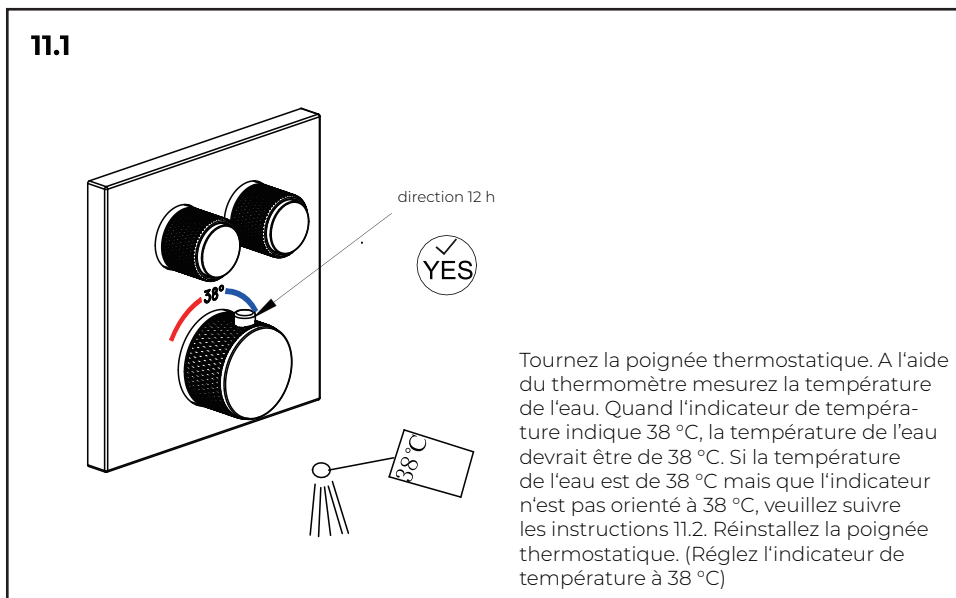
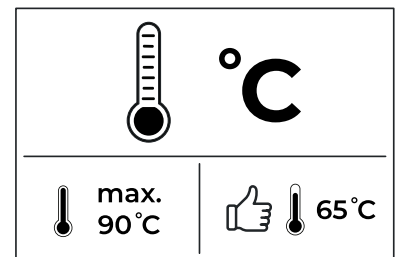
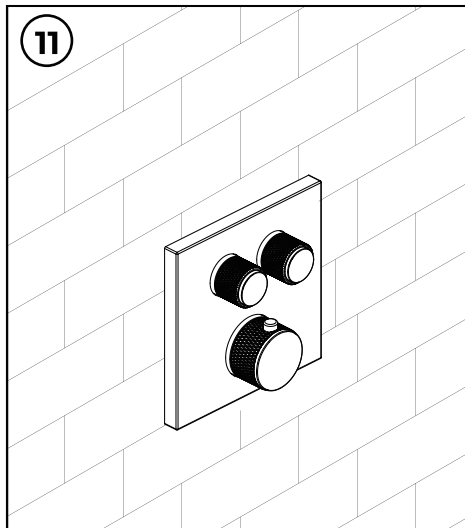
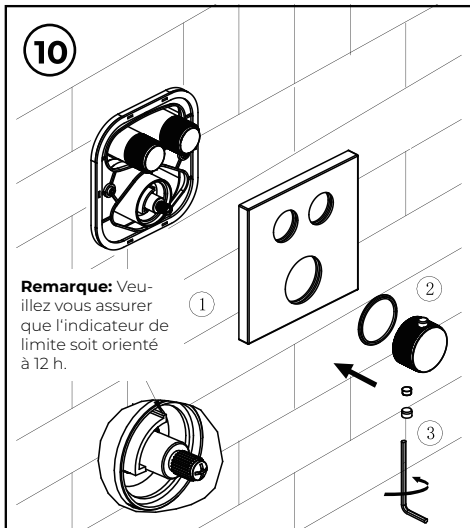
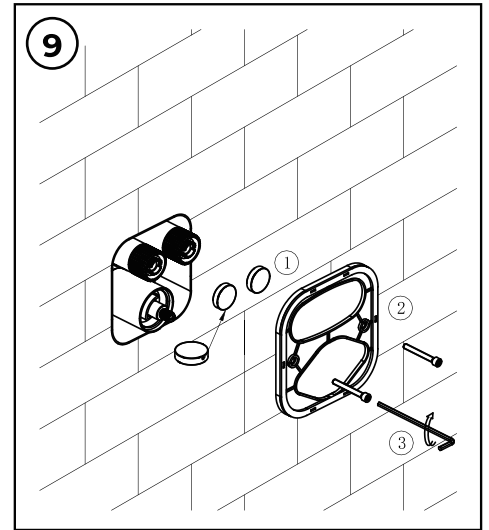
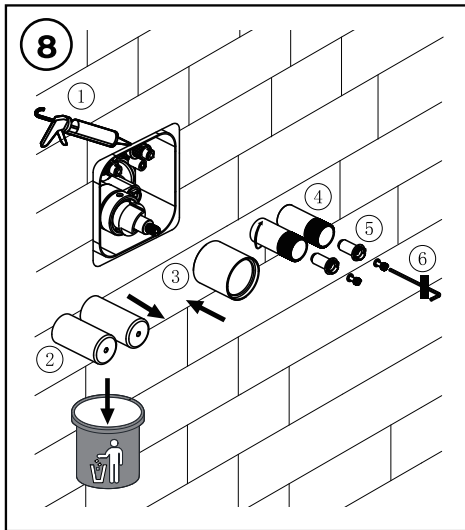
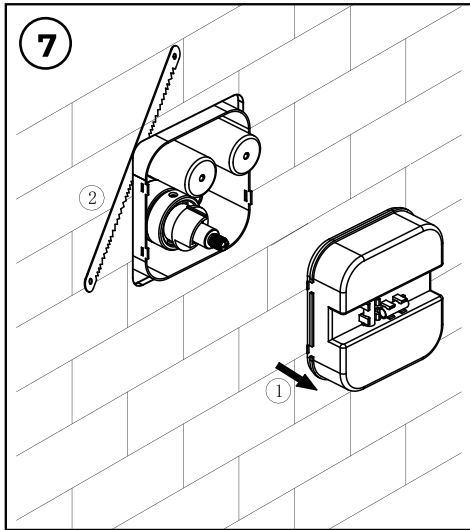

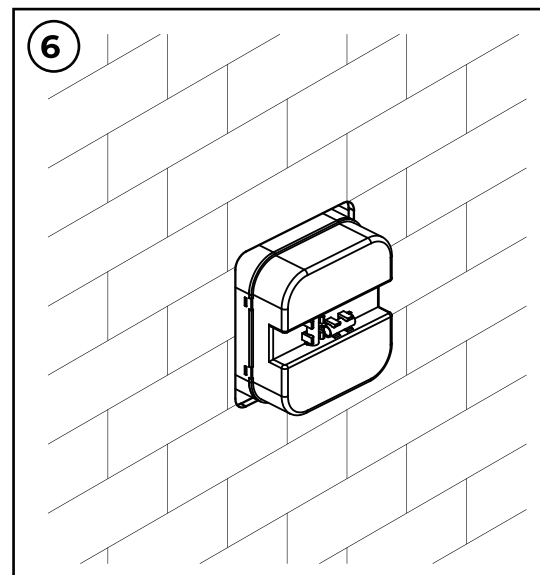
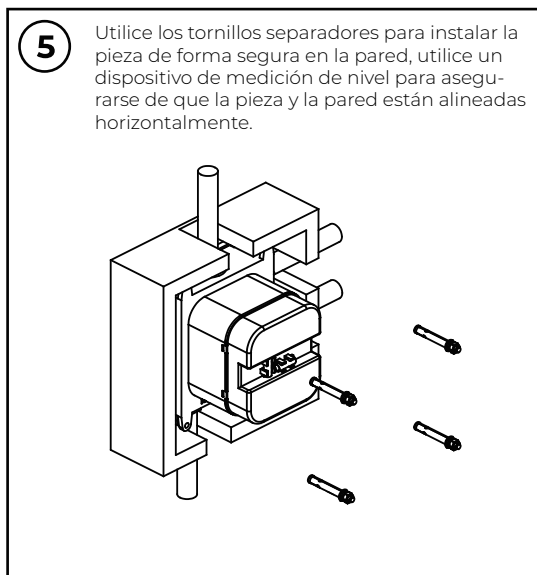
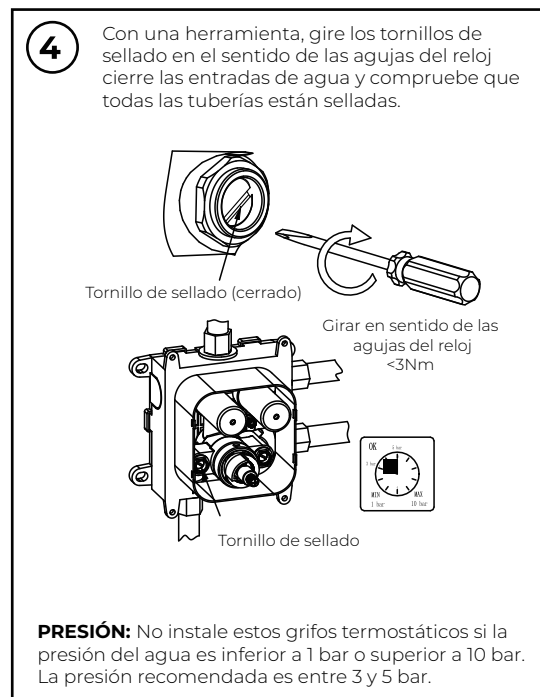
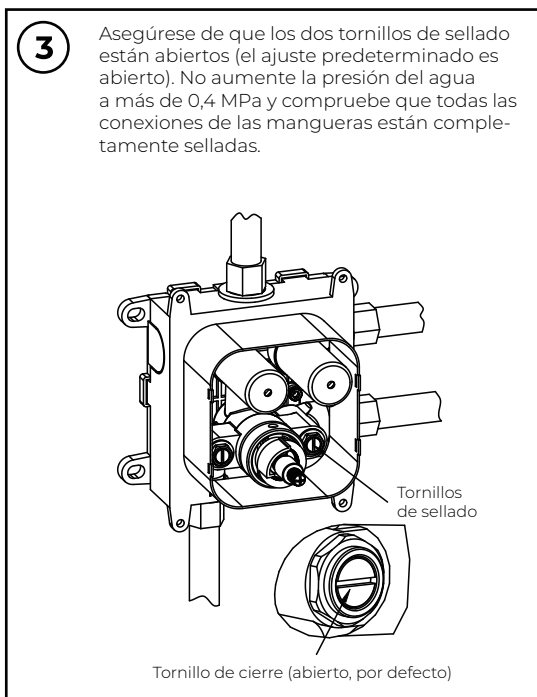
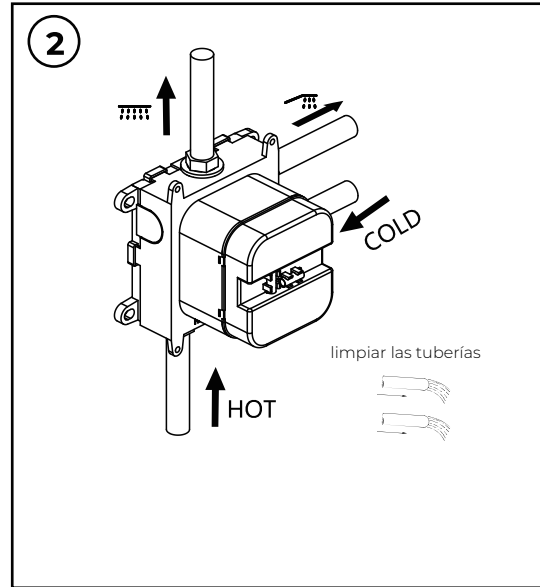
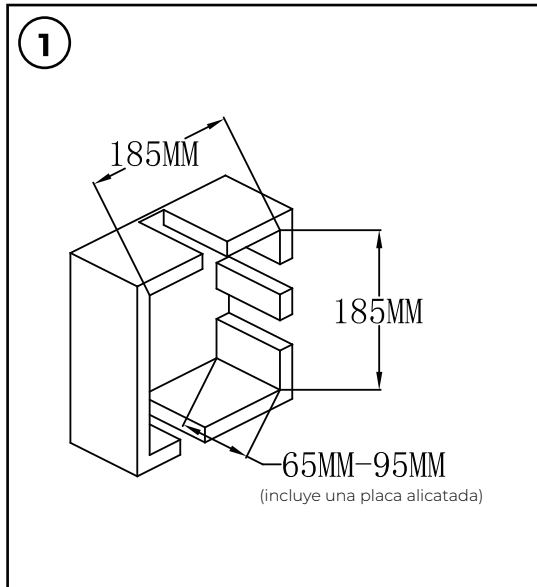

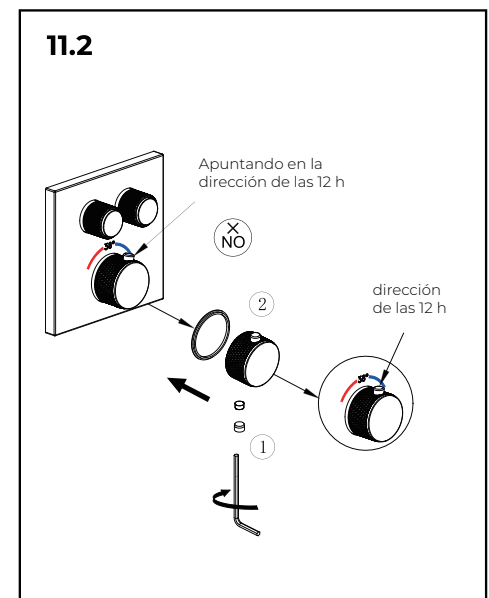
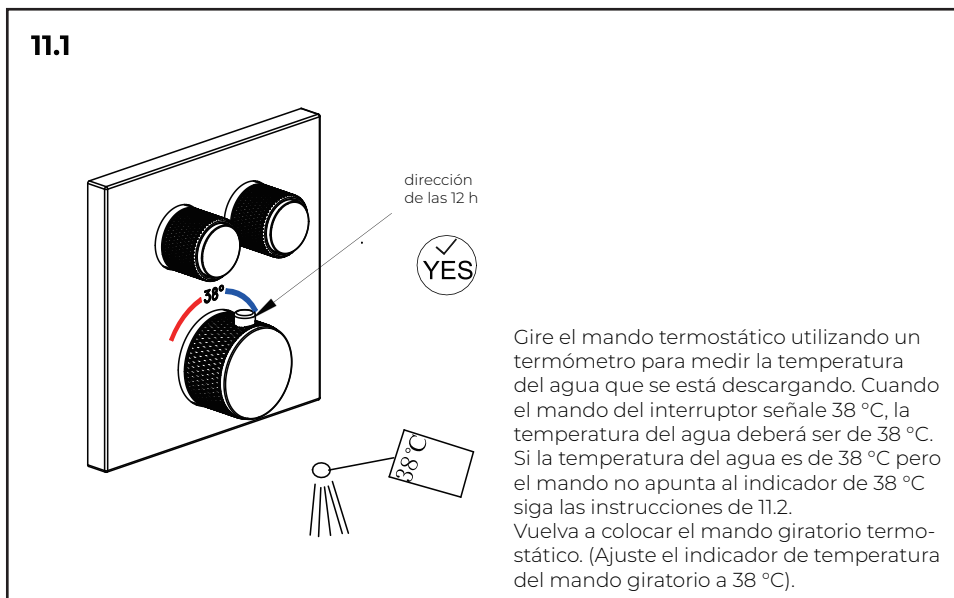
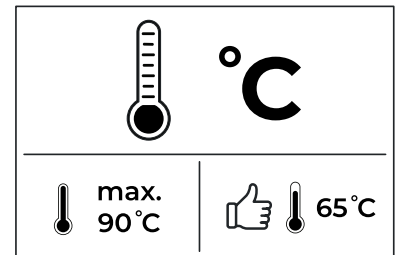
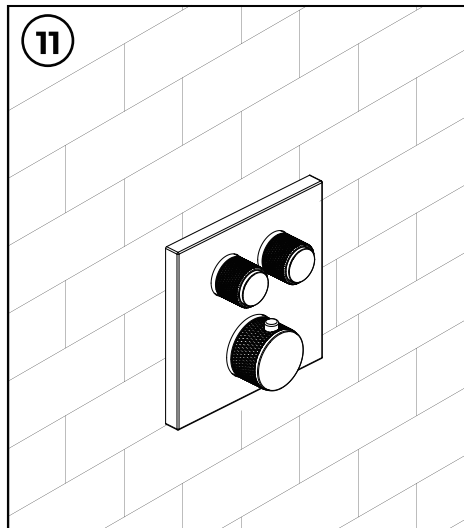
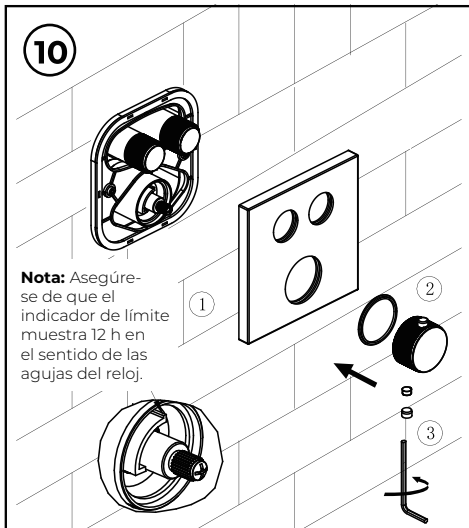
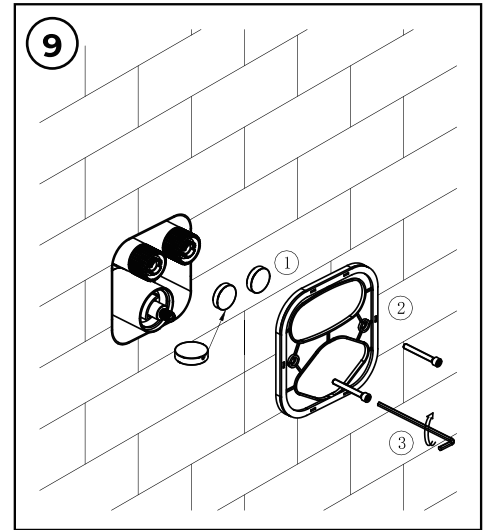
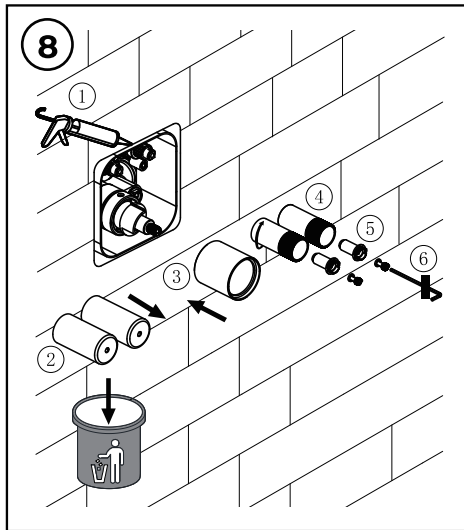
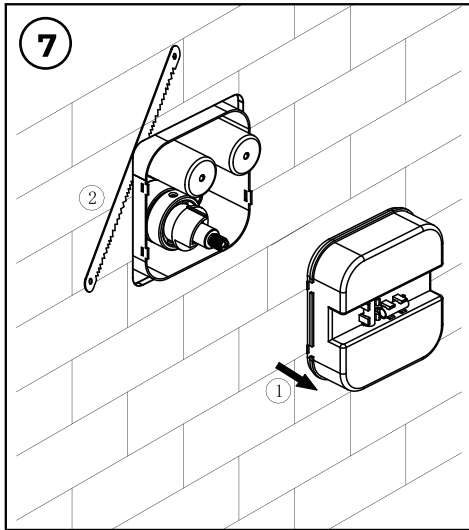

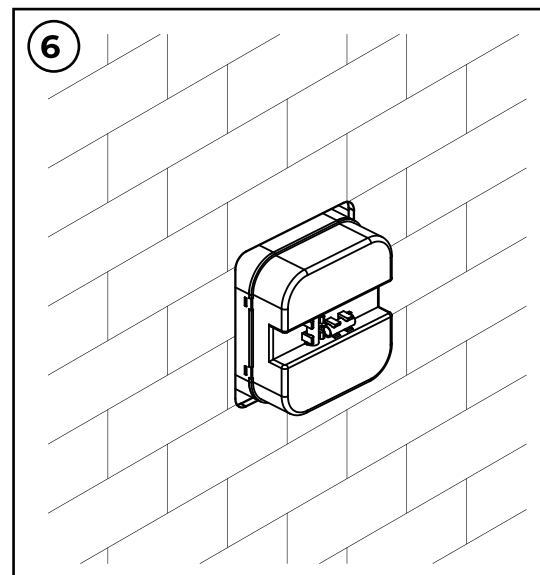
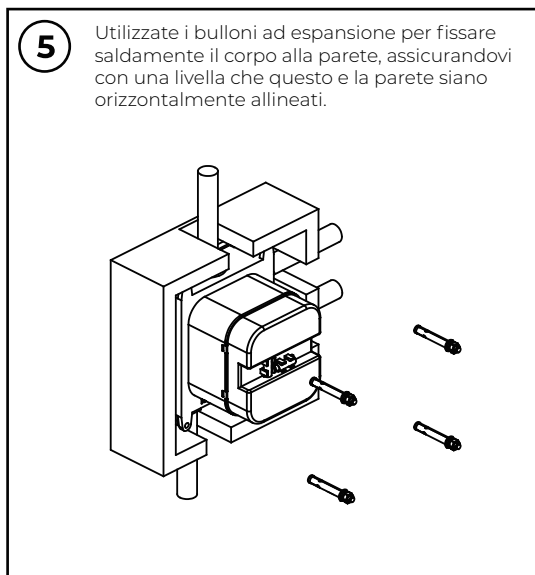
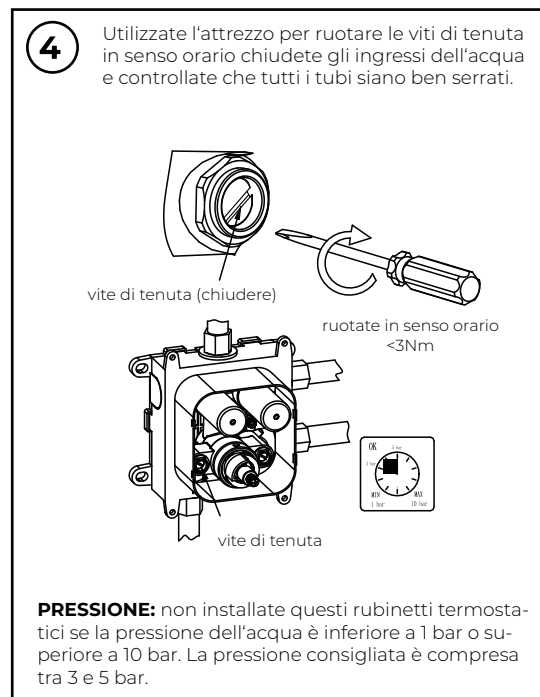
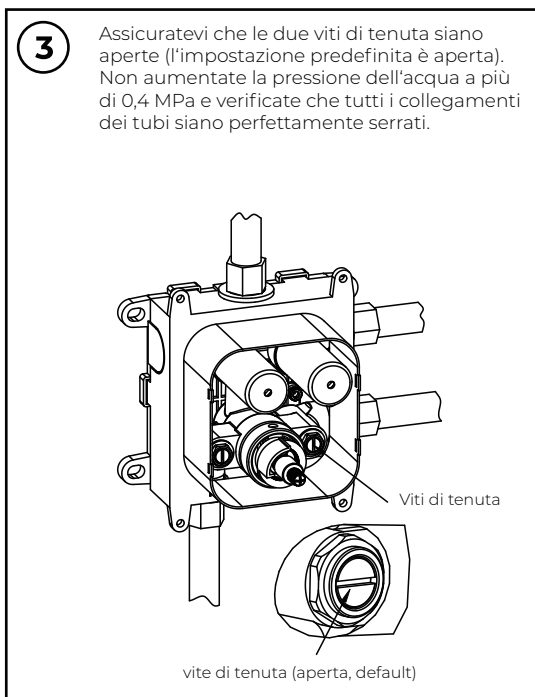
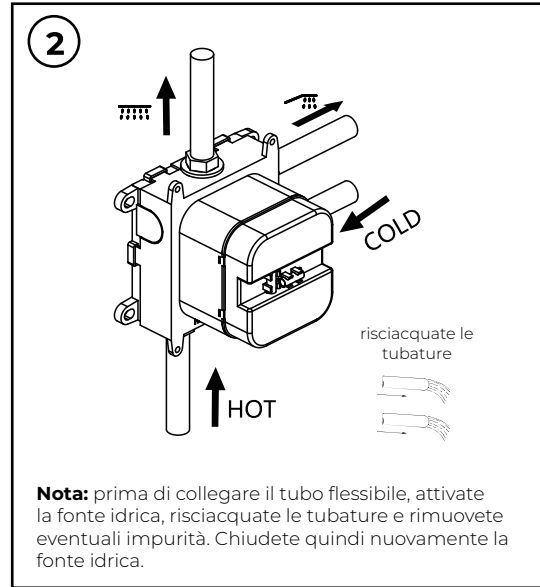
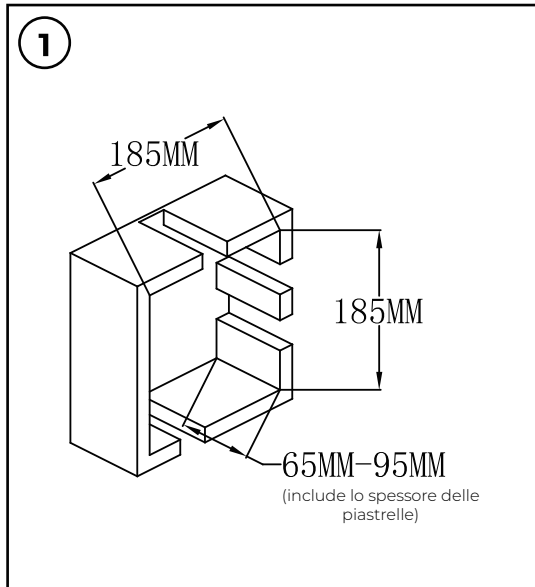

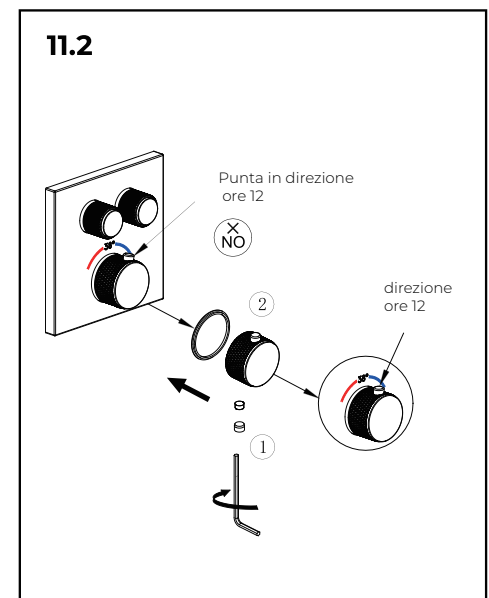
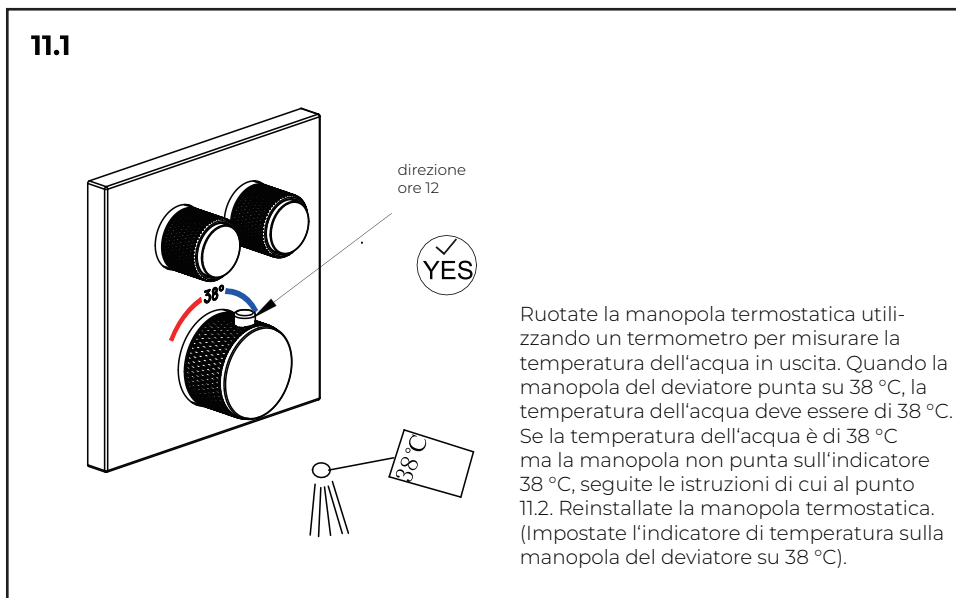
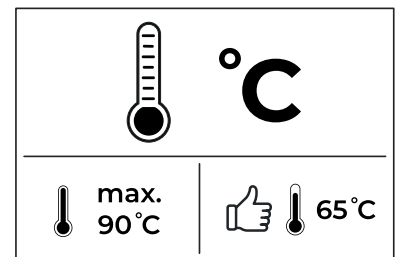
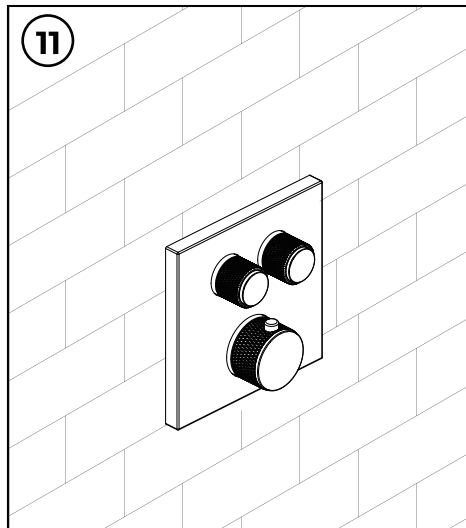
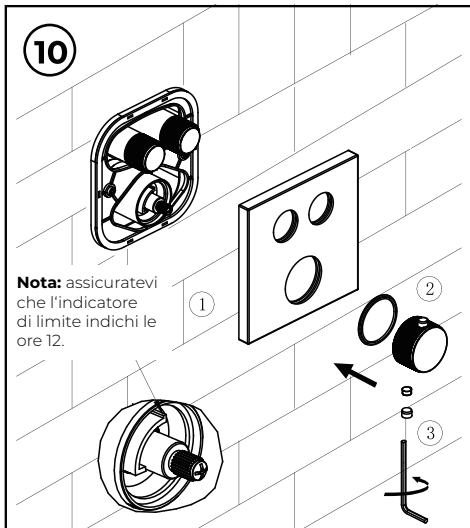
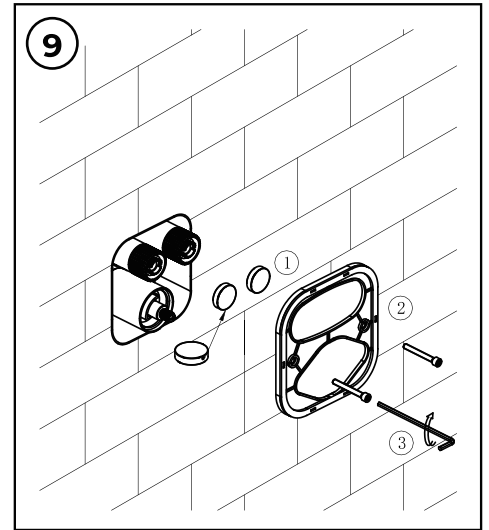
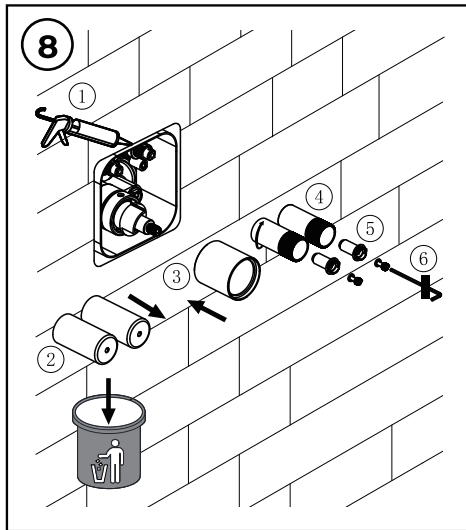
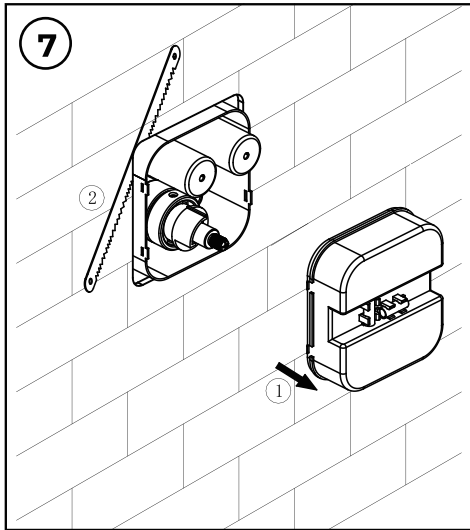

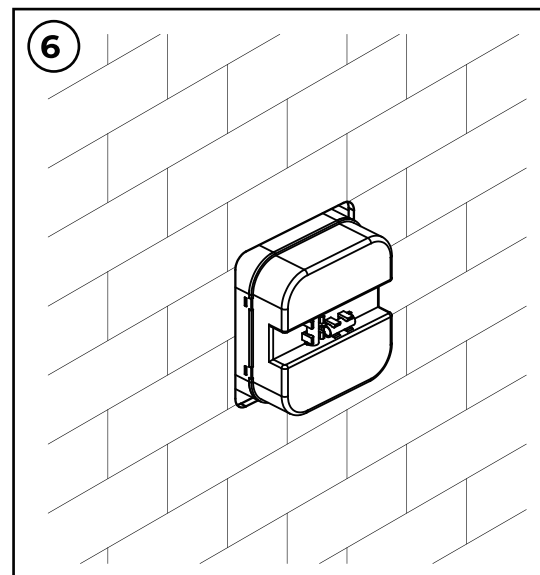
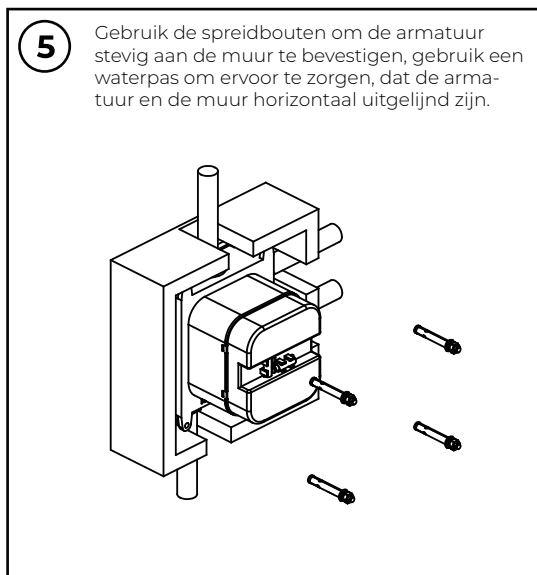
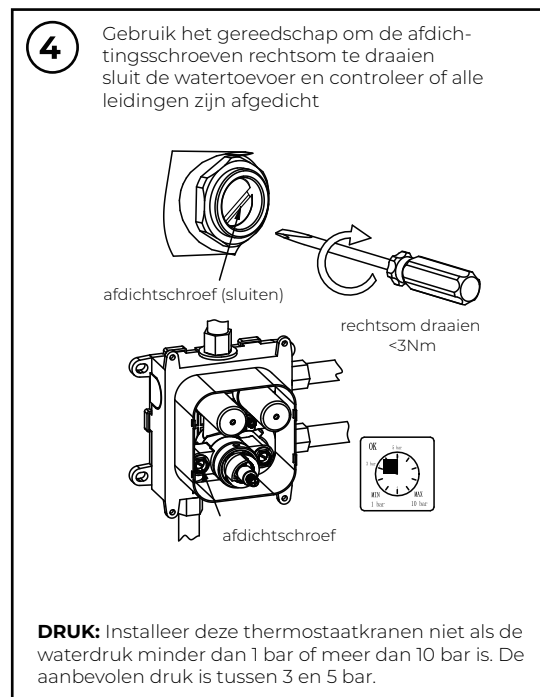
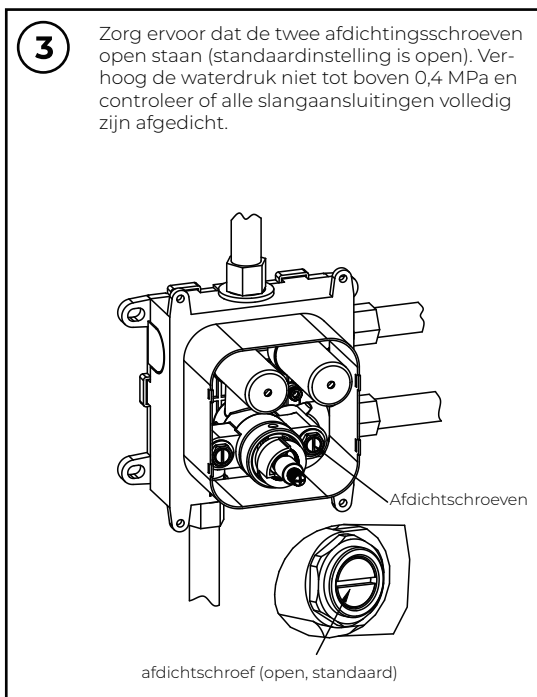
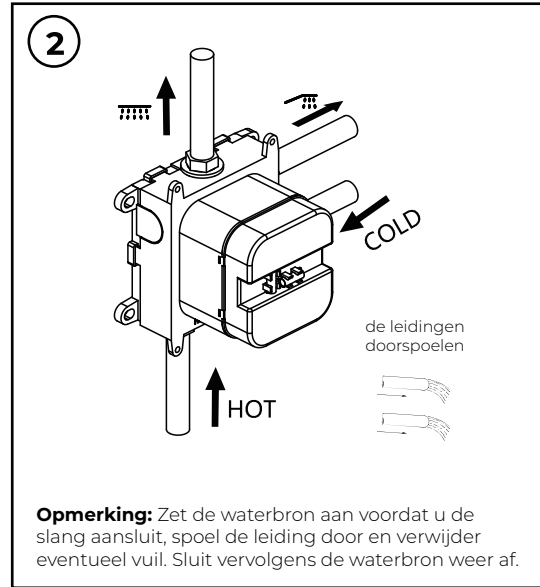
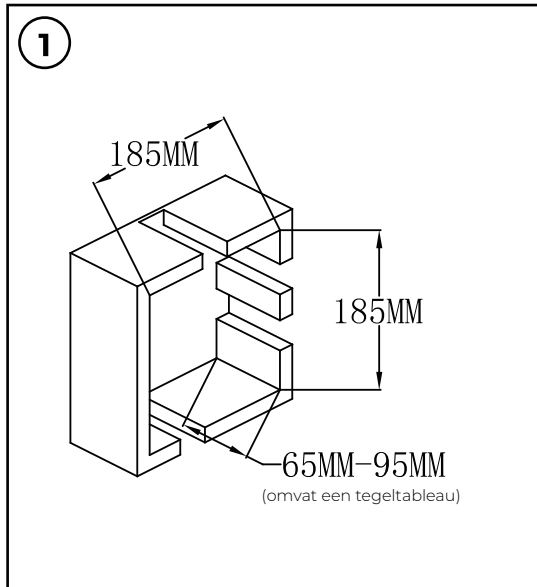

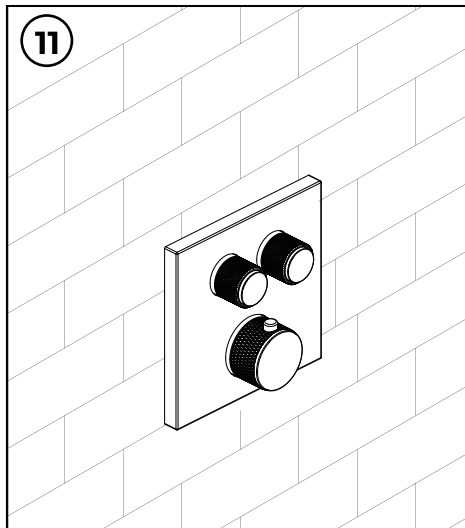
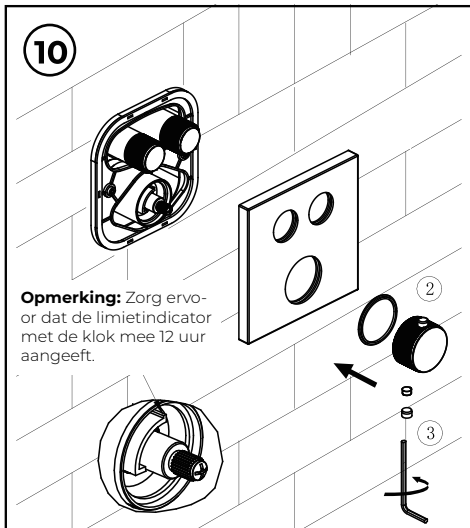
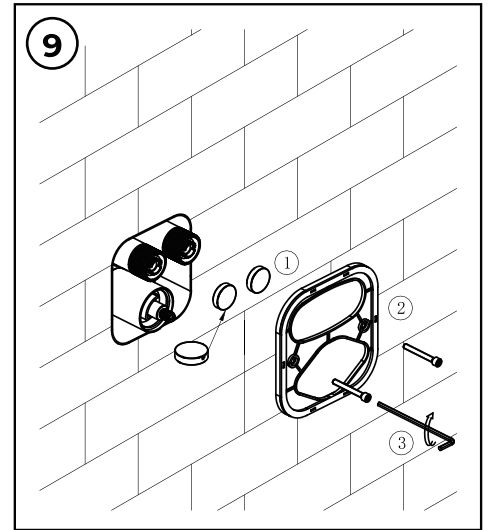
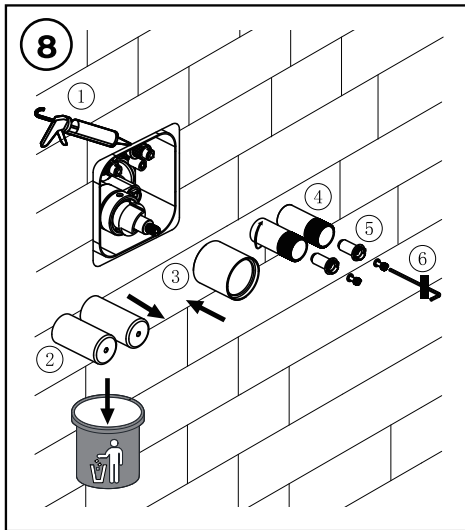
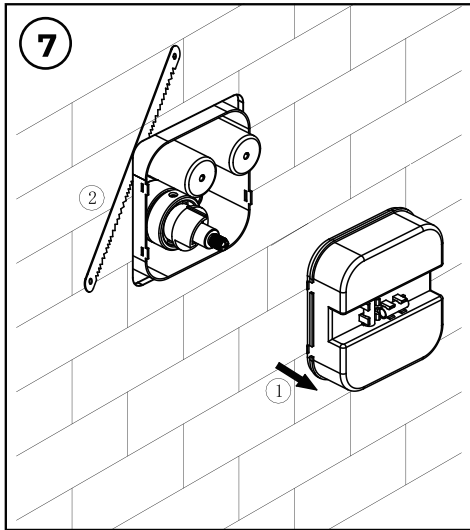

**bar**

0,5 max. 10

5 1

**°C**

max. 90°C

65°C

**11.1**

richting 12 uur

38°C

YES

Draai aan de thermostaatknop en meet met een thermometer de temperatuur van het geloosde water. Als de knop van de schakelaar naar 38 °C wijst, moet de watertemperatuur 38 °C zijn. Als de watertemperatuur 38 °C is, maar de knop niet naar de 38 °C indicator wijst, volg dan de instructies in 11.2. Plaats de thermostatische draaiknop terug. (Zet de temperatuurindicator op de draaiknop op 38 °C).

**11.2**

Wijzend in de richting van 12 uur

NO

richting 12 uur

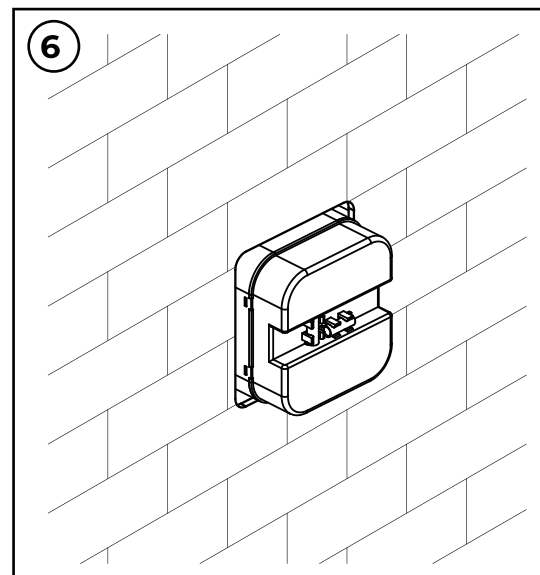
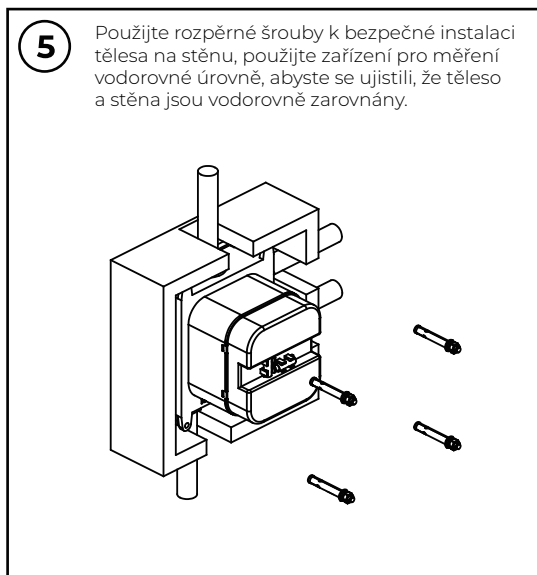
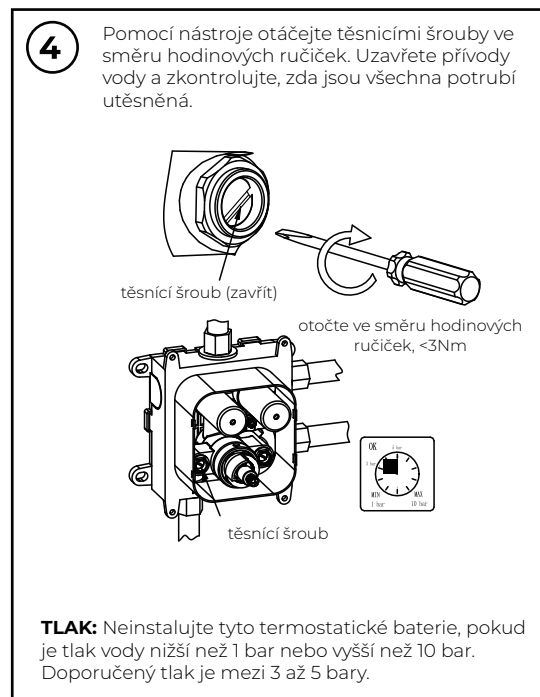
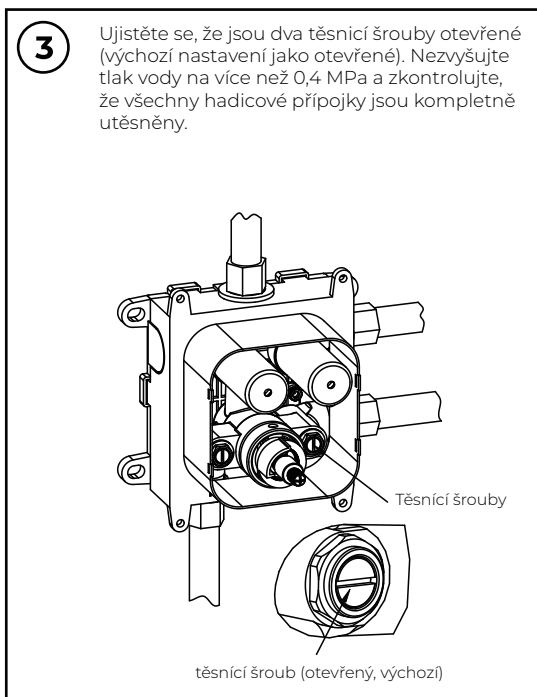
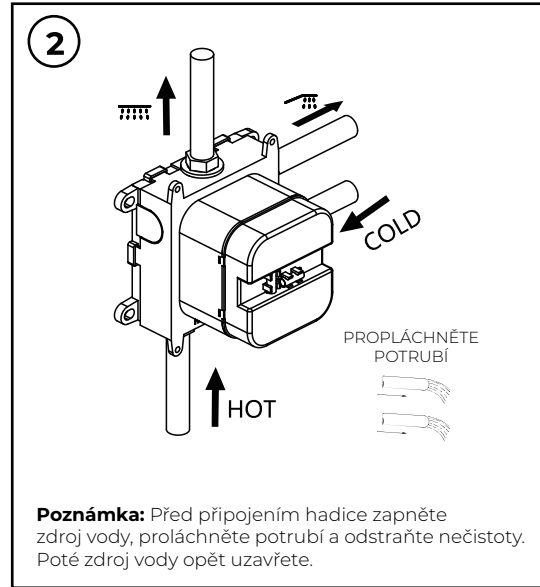
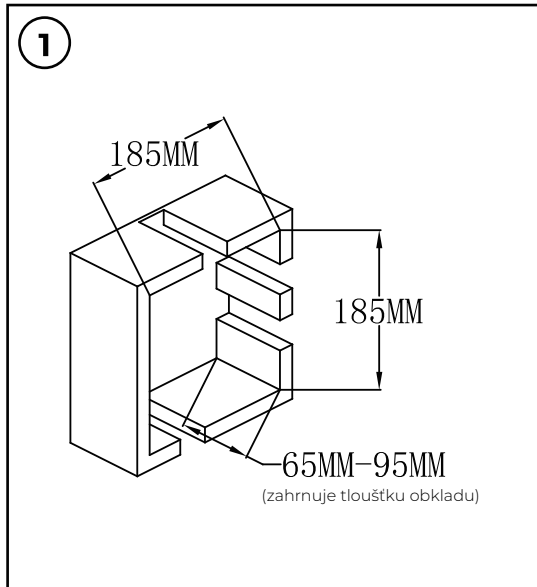

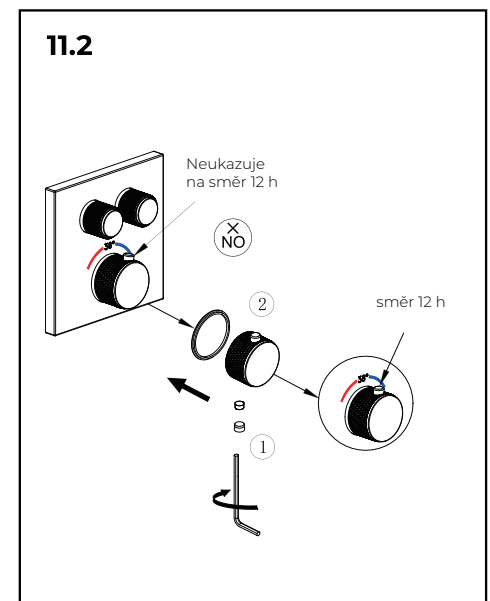
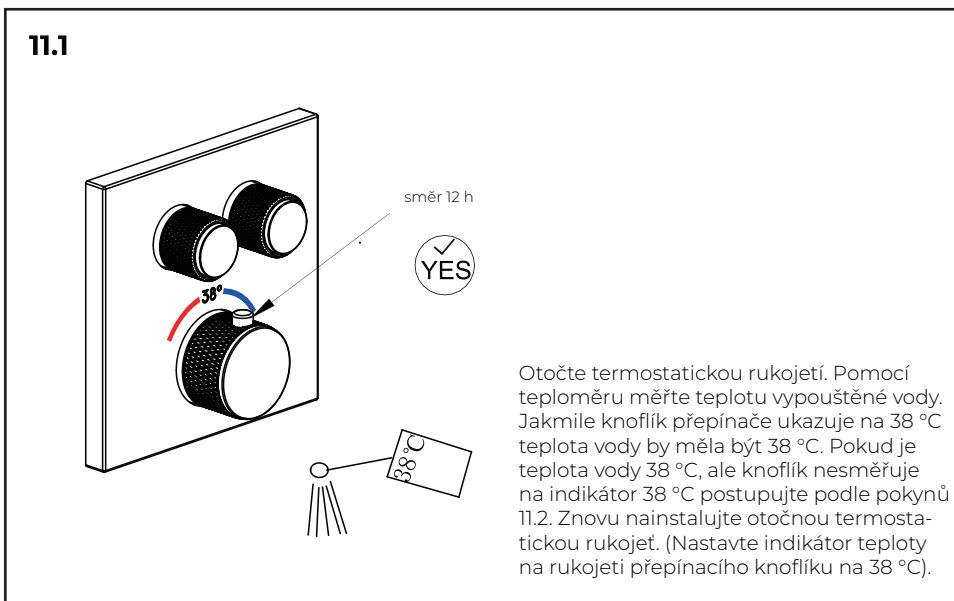
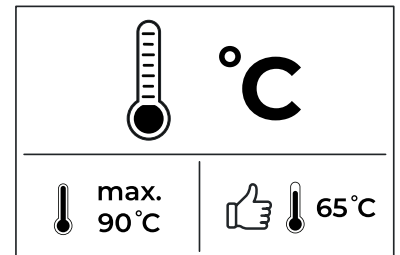
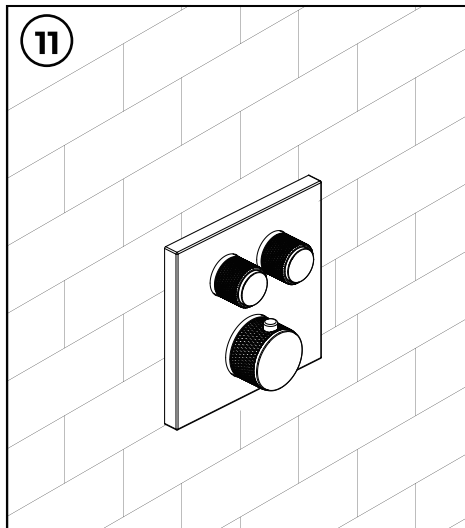
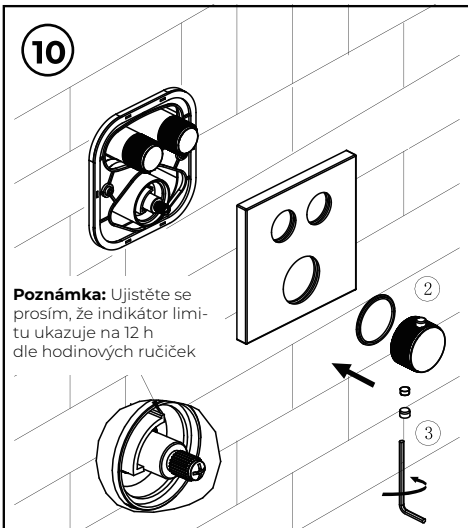
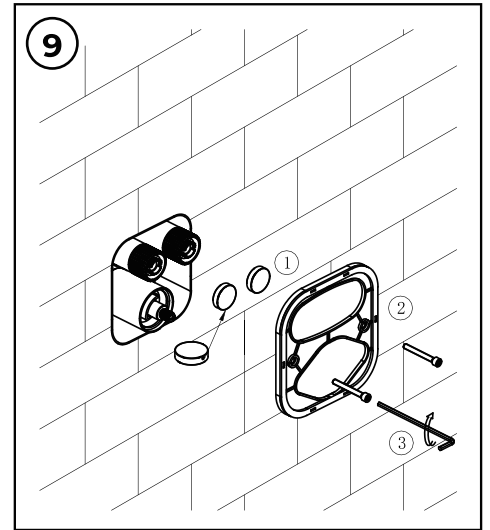
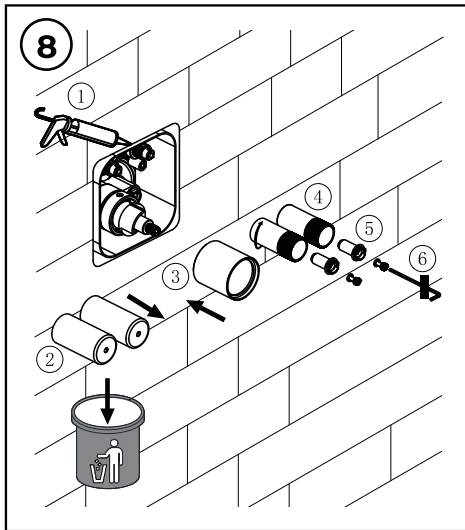
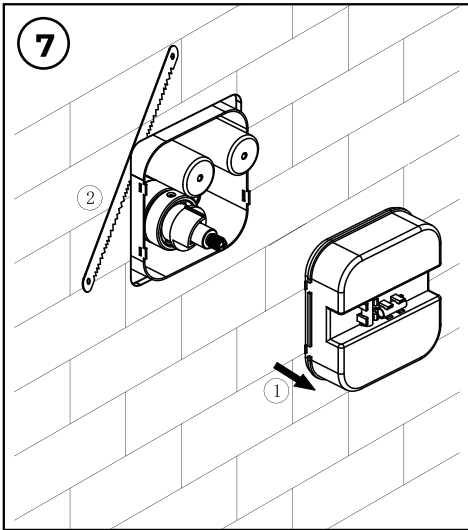

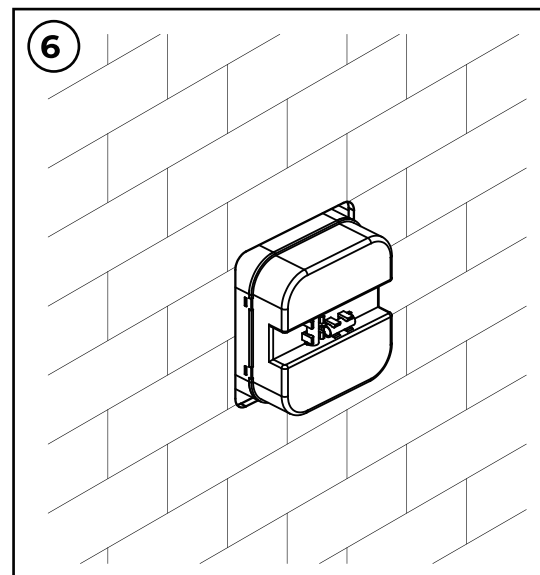
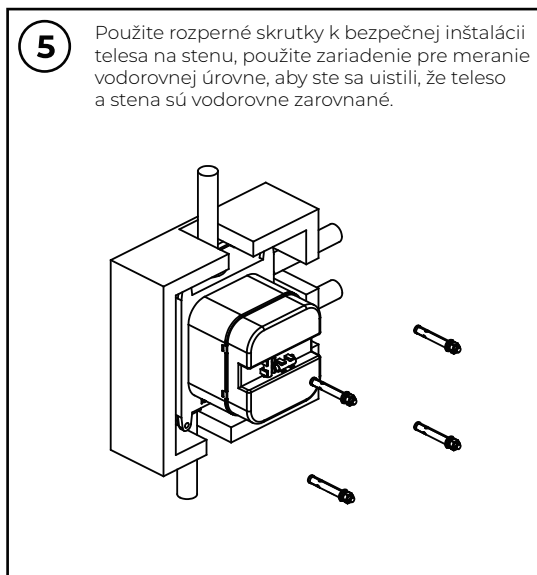
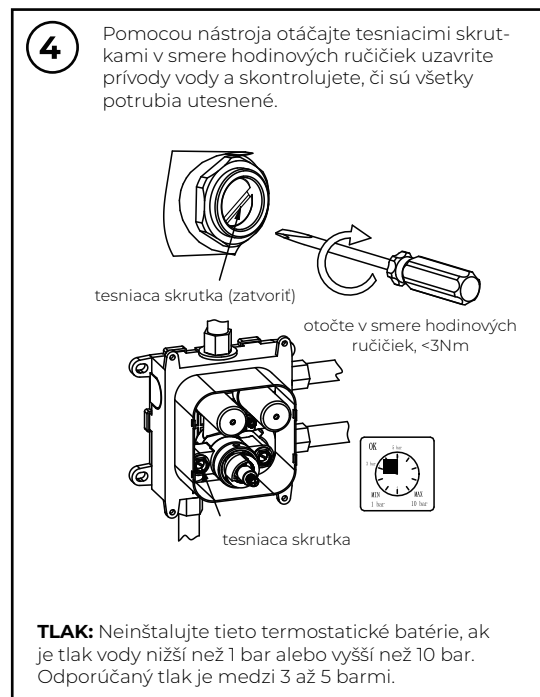
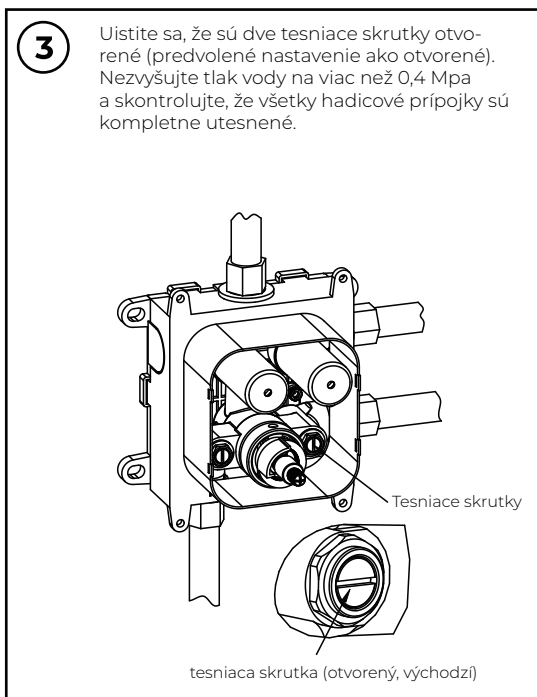
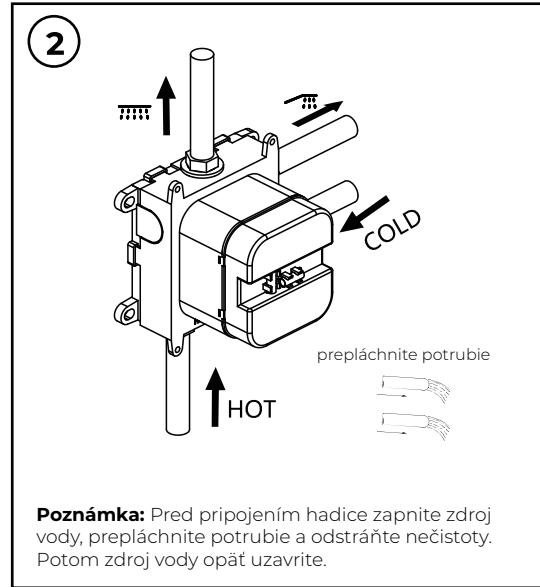
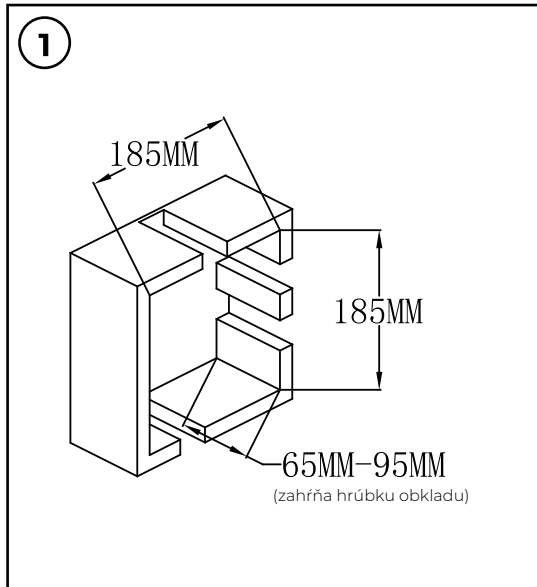

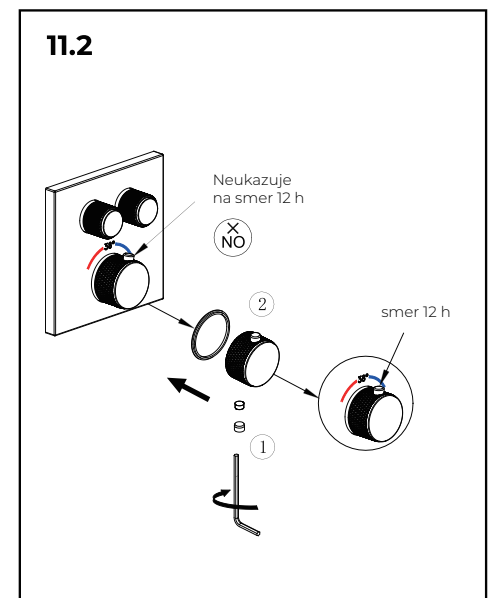
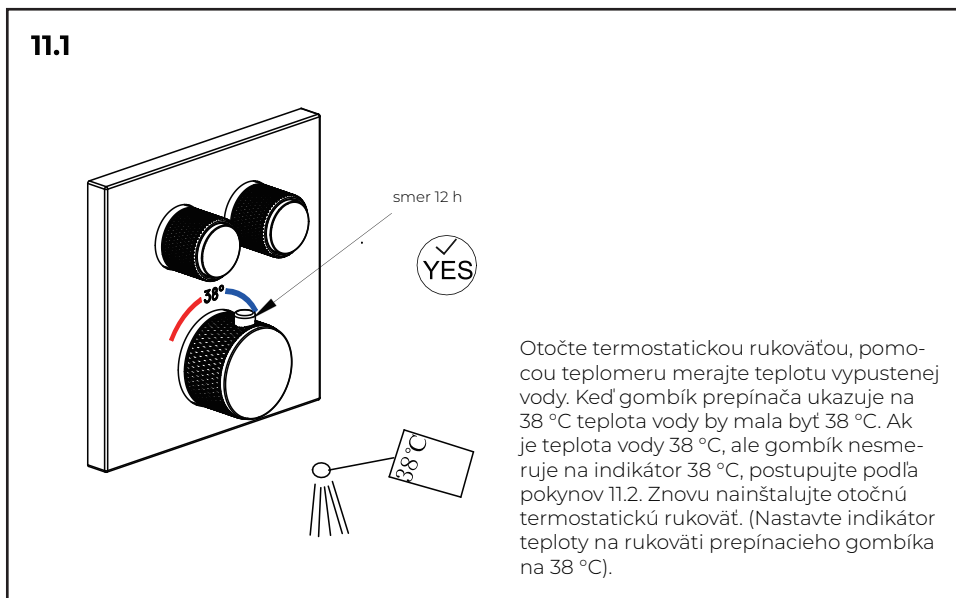
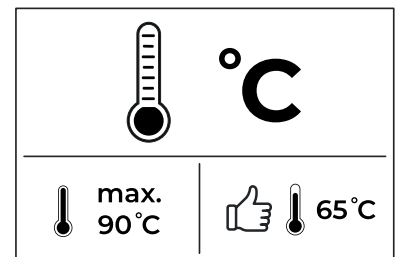
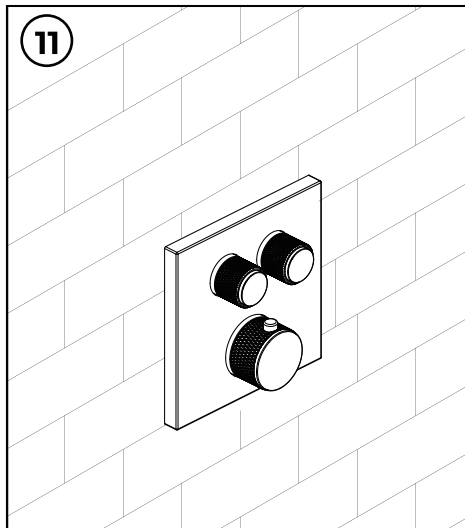
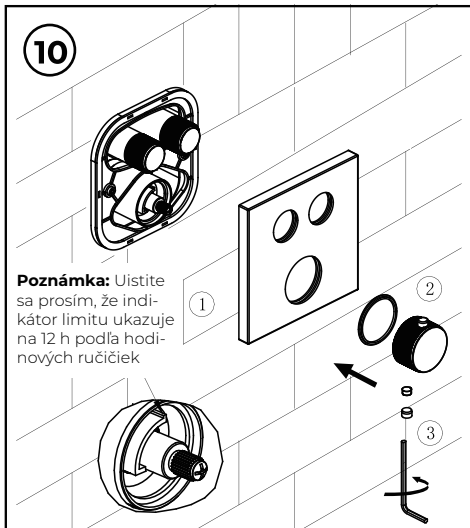
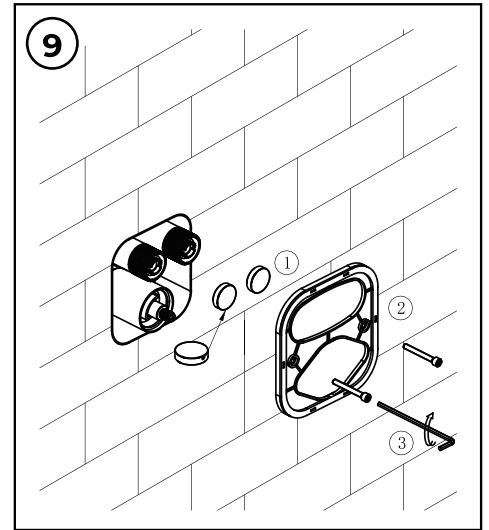
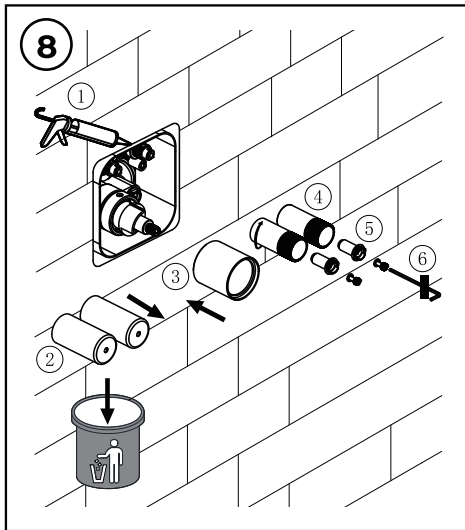
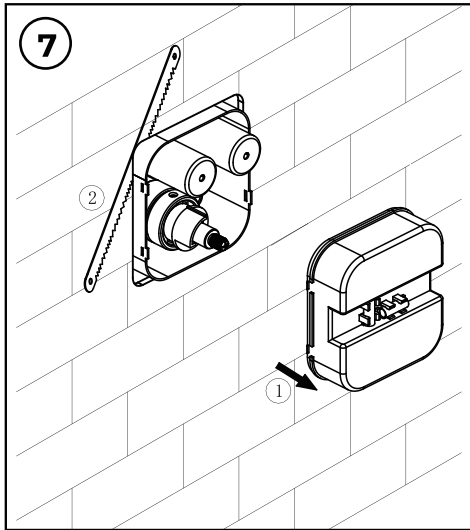

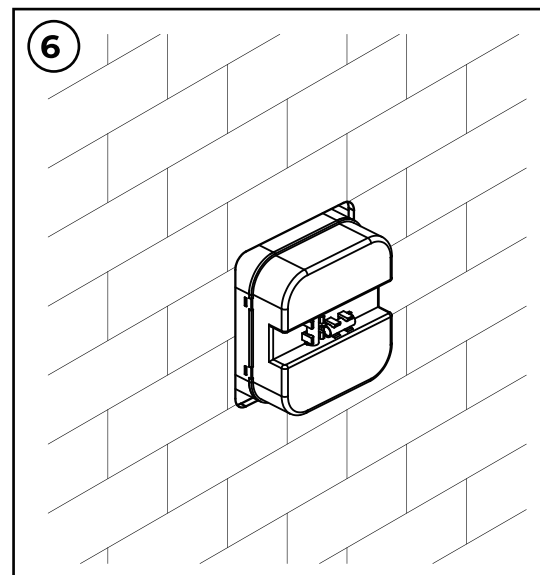
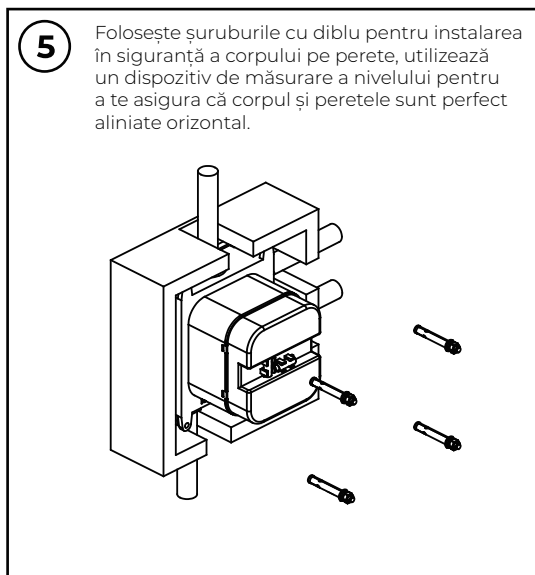
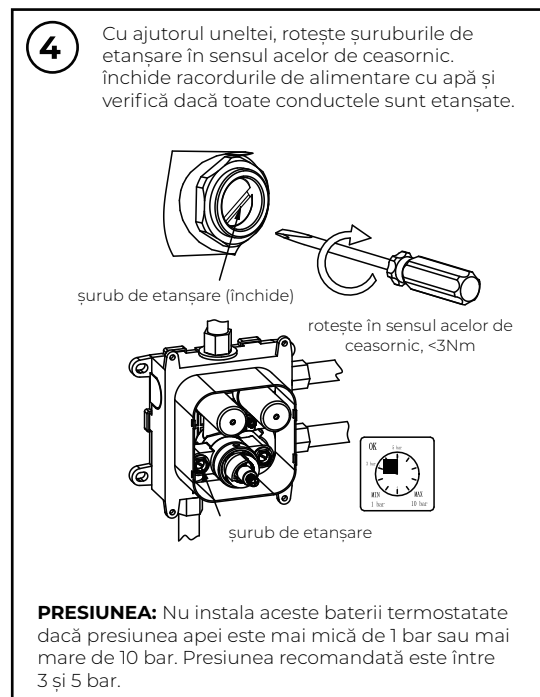
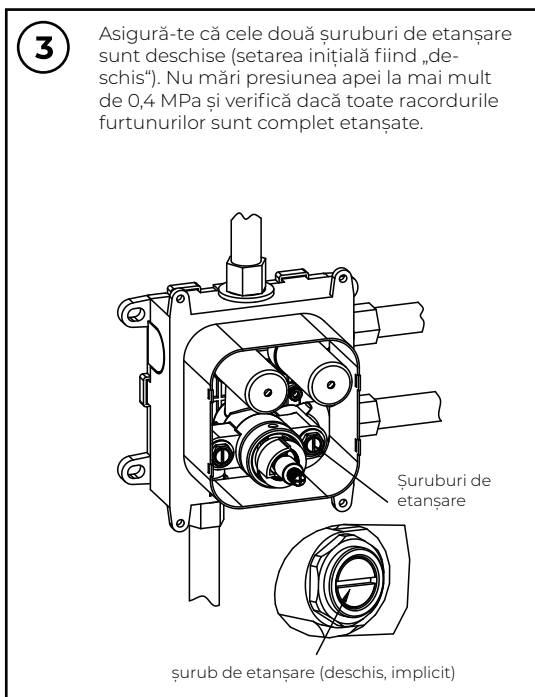
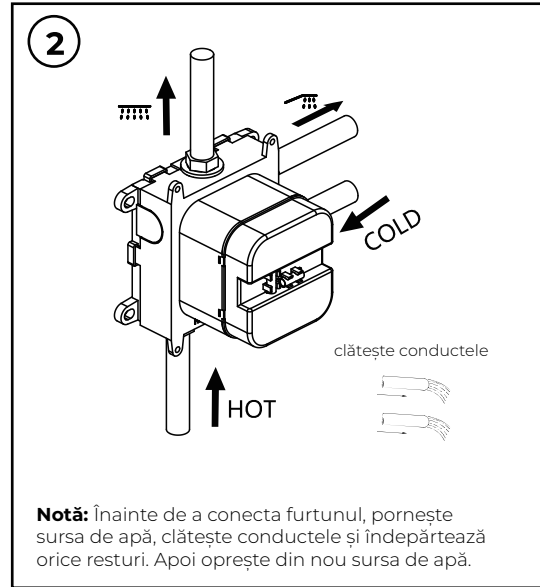
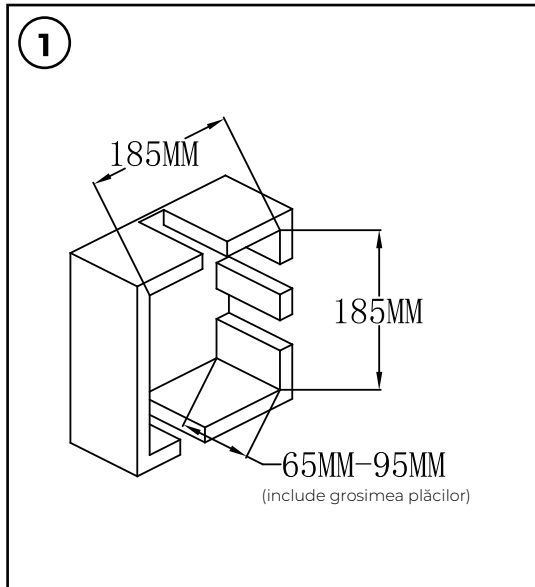

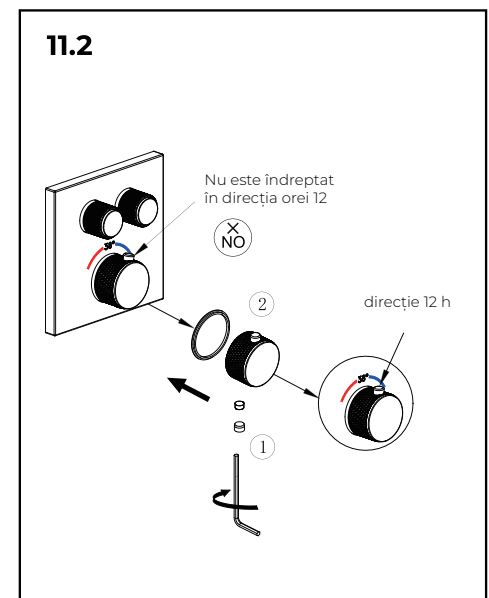
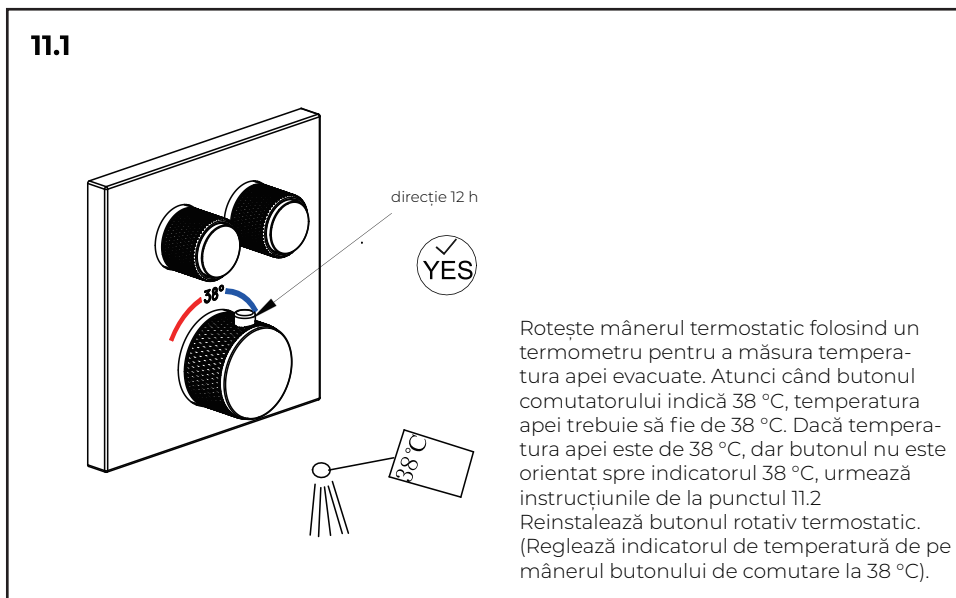
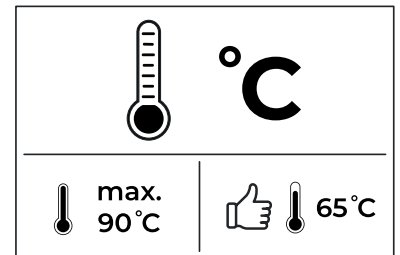
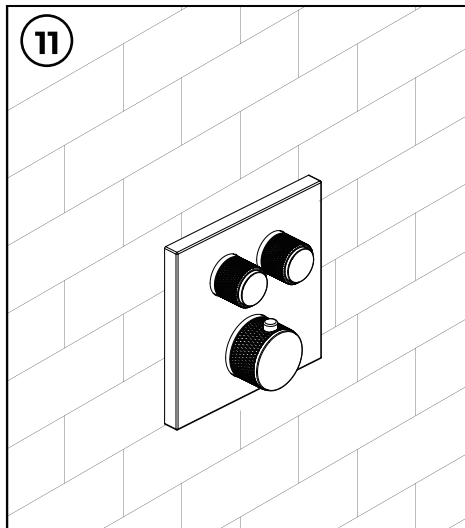
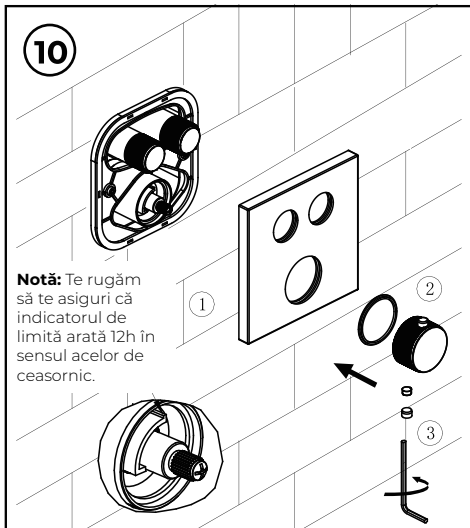
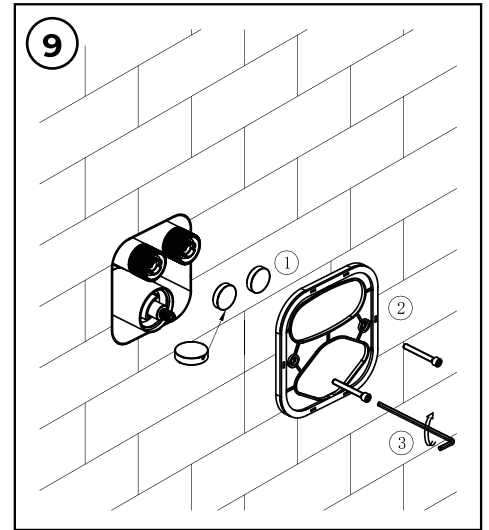
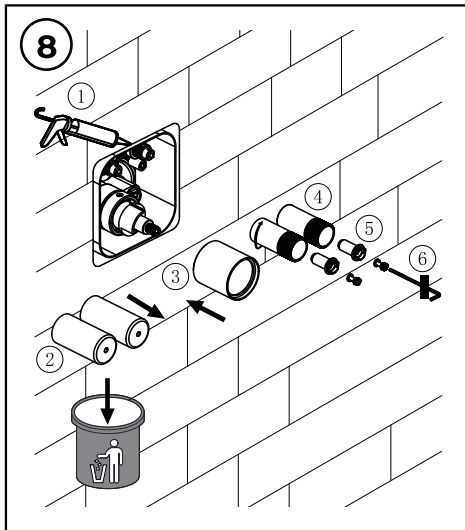
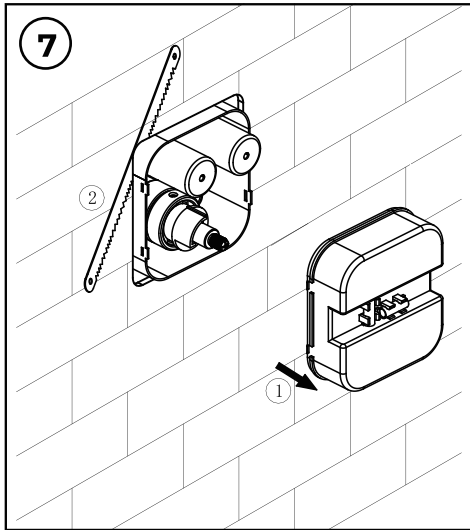

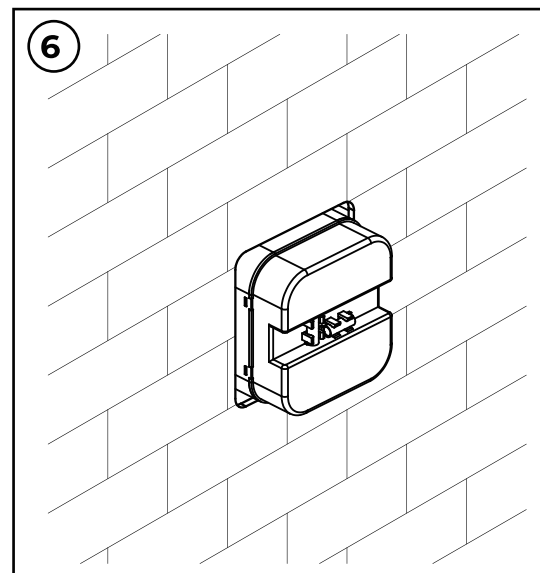
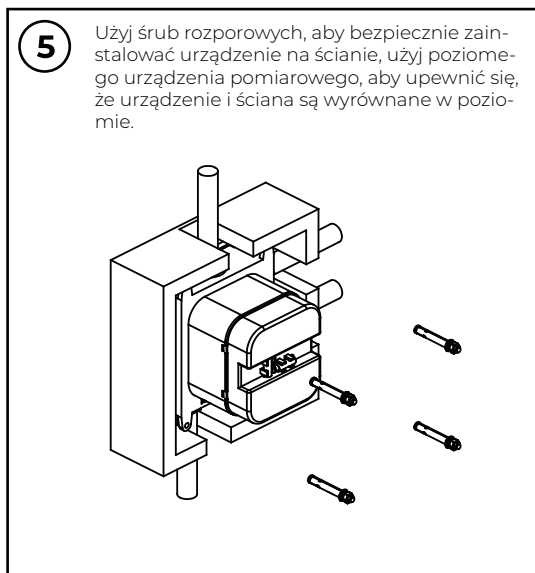
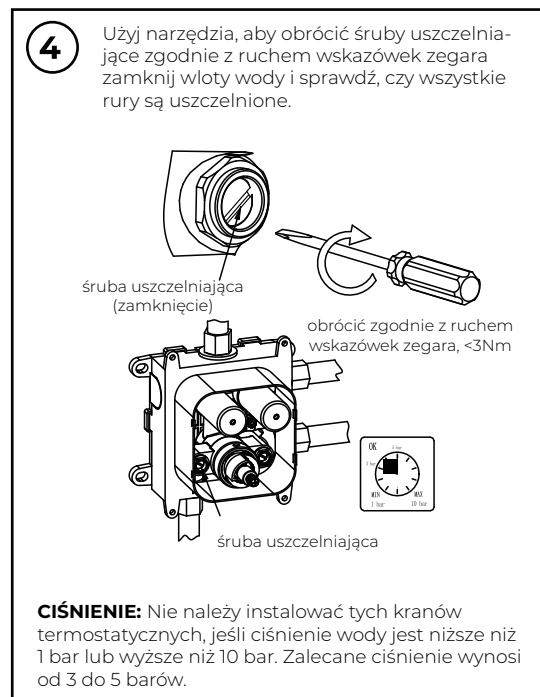
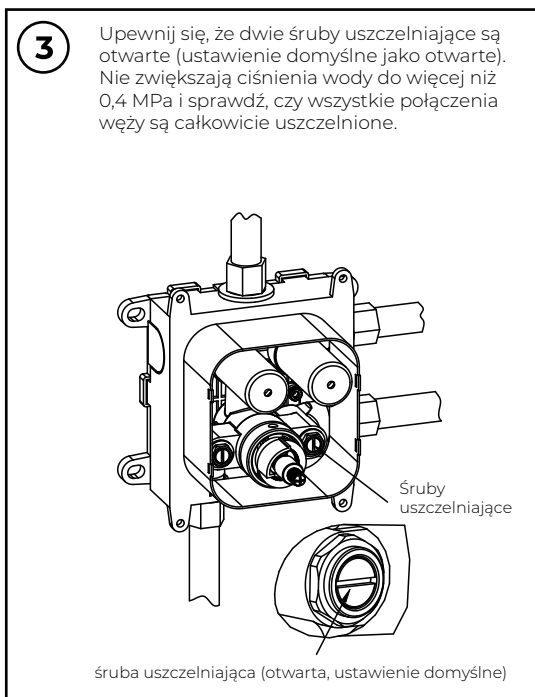
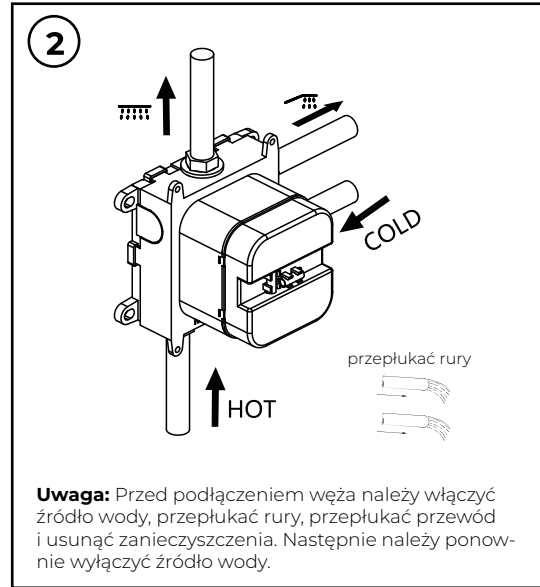
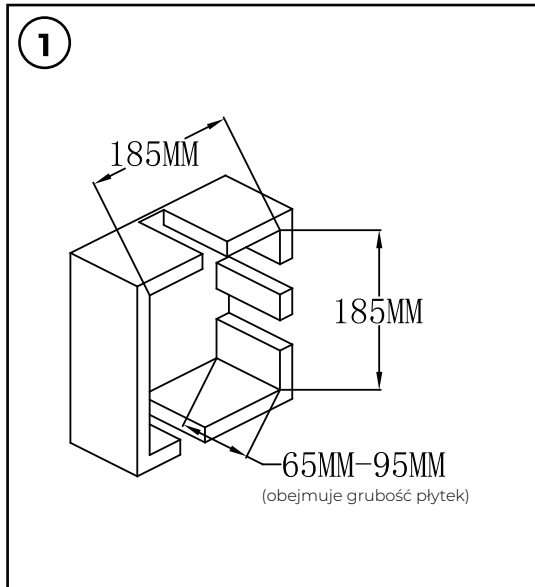

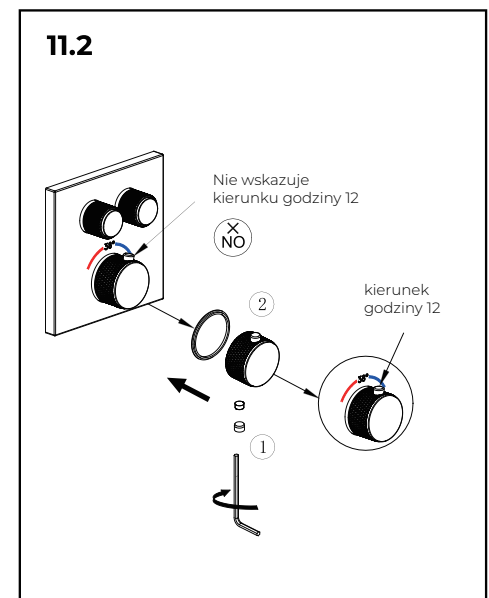
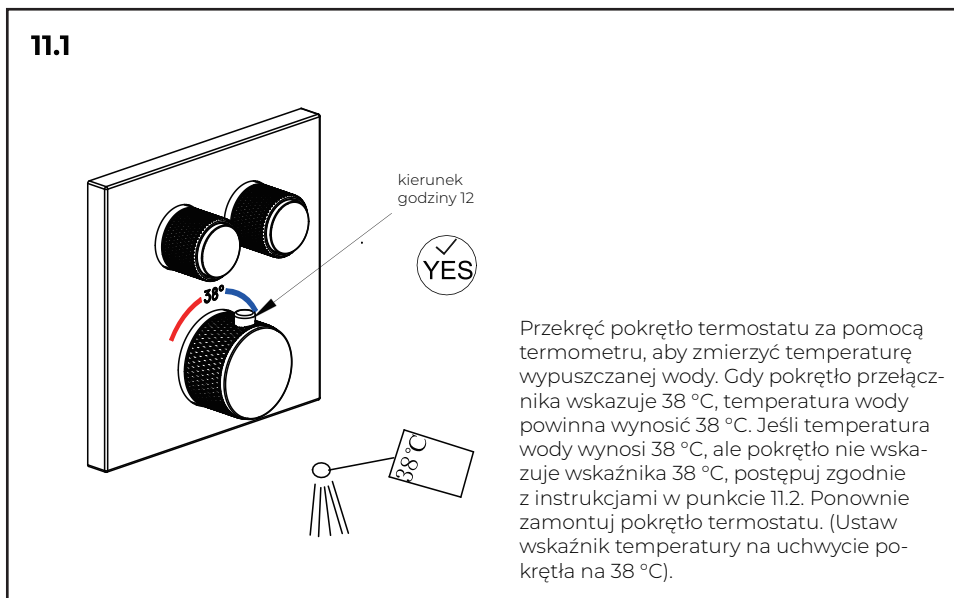
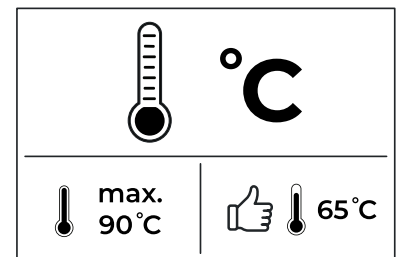
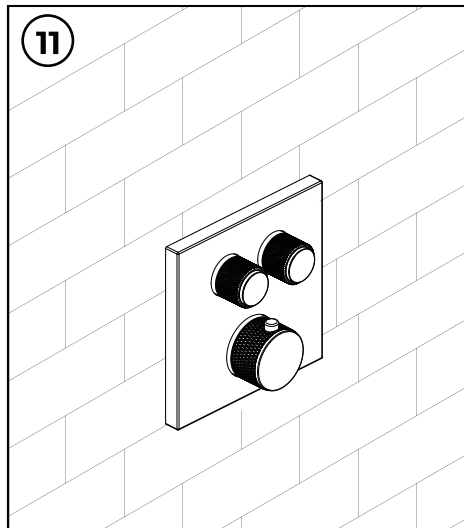
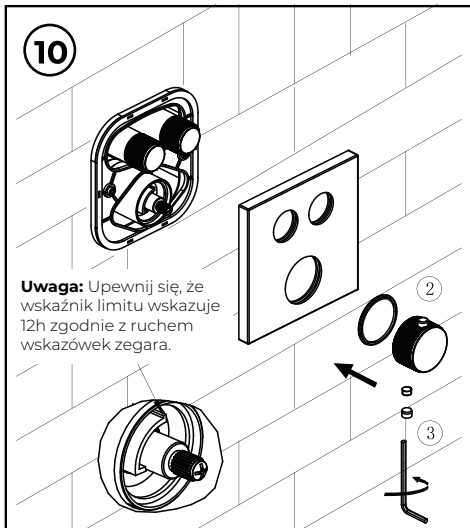
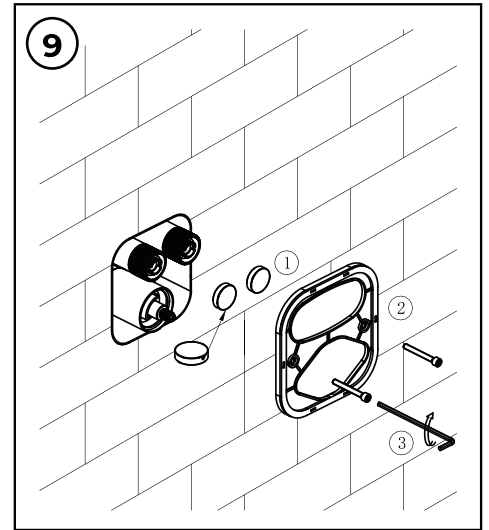
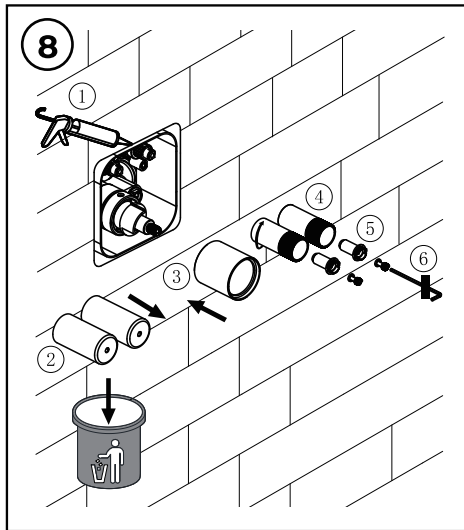
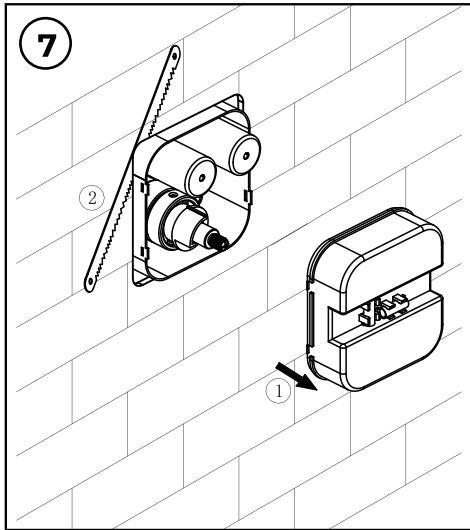

# kielle

2.

3.

4.

1.

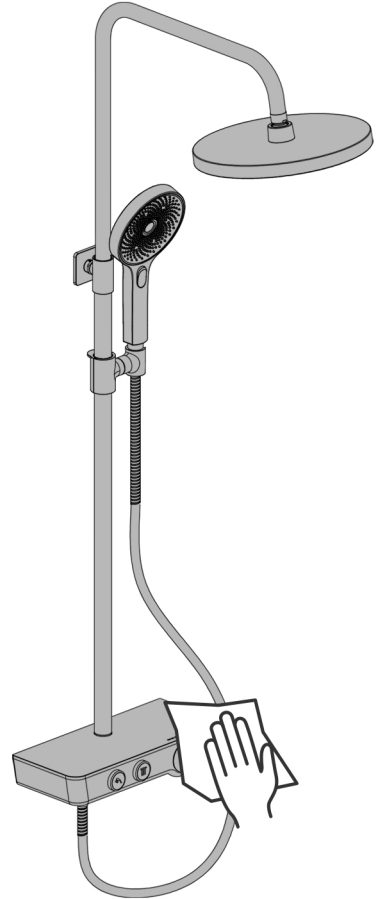
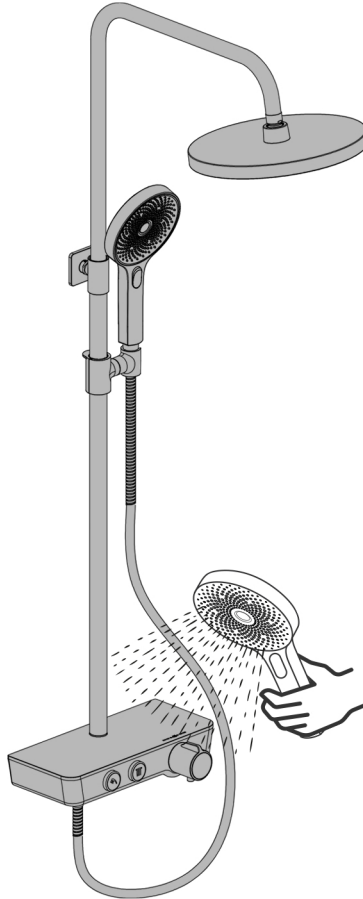
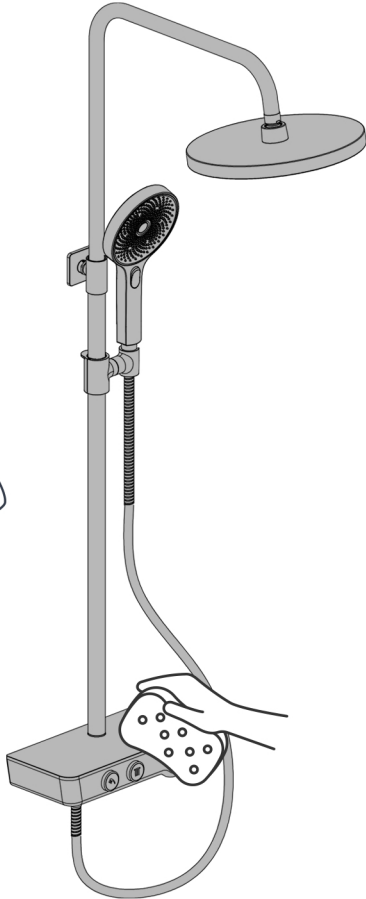

1.



2.

TIPS

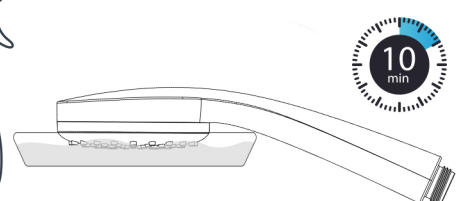
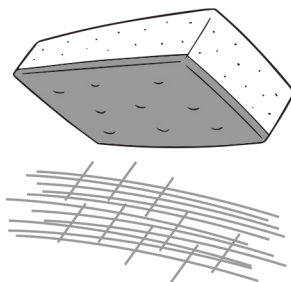
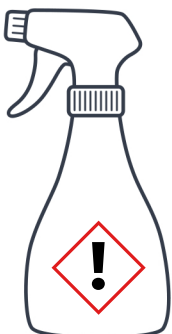
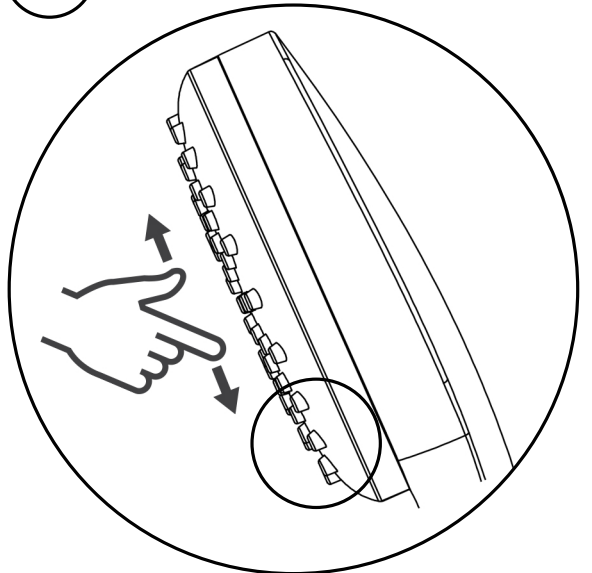

10 min