

bar

0,5 max. 10

5 1

°C

max. 90°C

65°C

11.1

richting 12 uur

38°C

YES

Draai aan de thermostaatknop en meet met een thermometer de temperatuur van het geloosde water. Als de knop van de schakelaar naar 38 °C wijst, moet de watertemperatuur 38 °C zijn. Als de watertemperatuur 38 °C is, maar de knop niet naar de 38 °C indicator wijst, volg dan de instructies in 11.2. Plaats de thermostatische draaiknop terug. (Zet de temperatuurindicator op de draaiknop op 38 °C).

11.2

Wijzend in de richting van 12 uur

NO

richting 12 uur

35°C

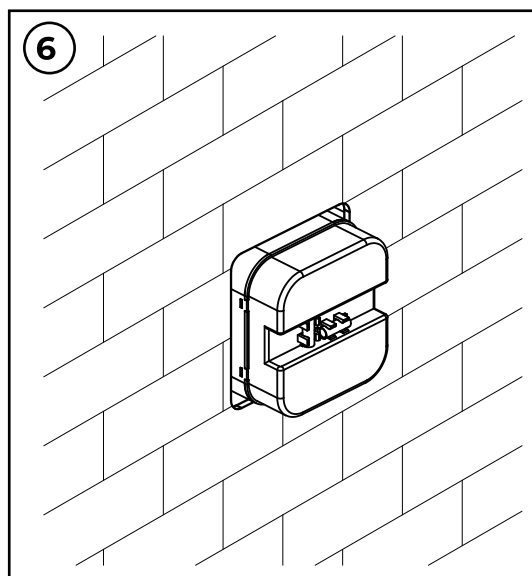
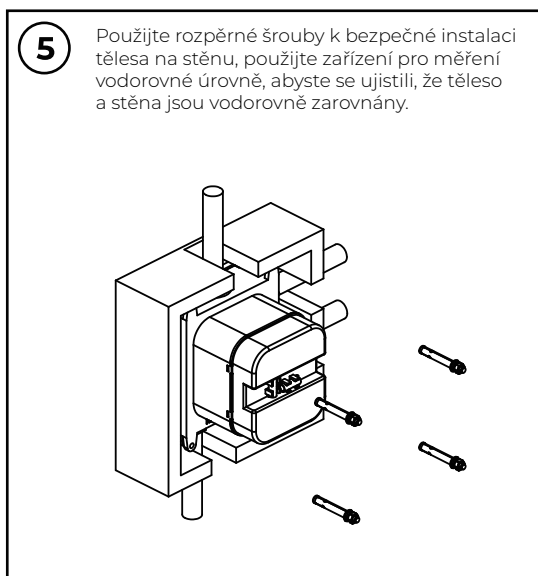
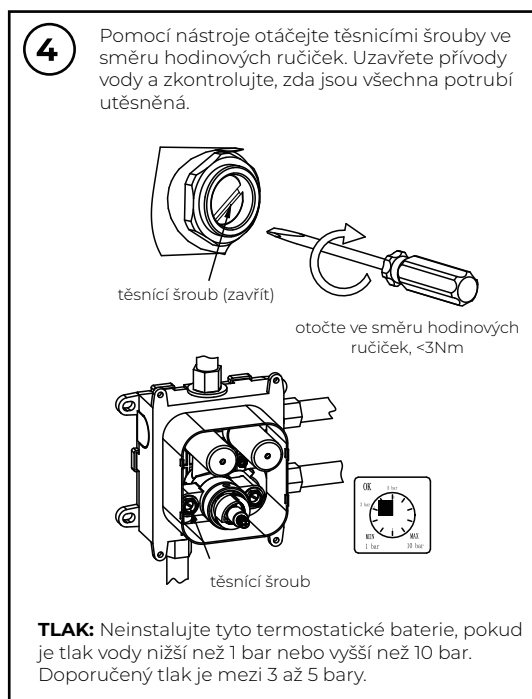
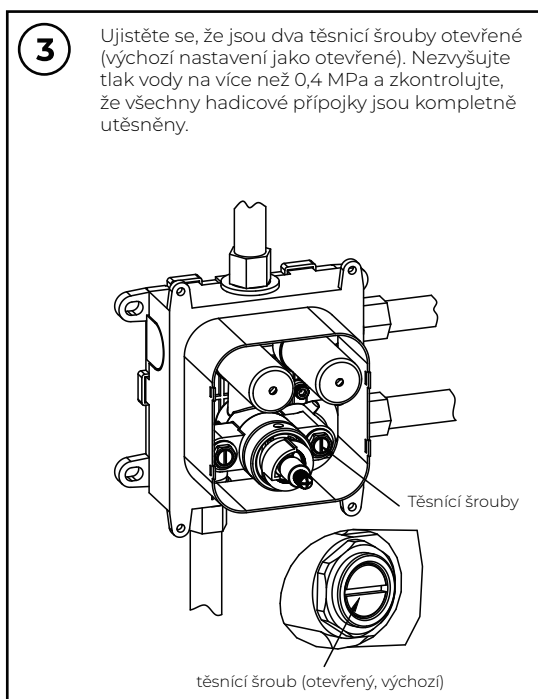
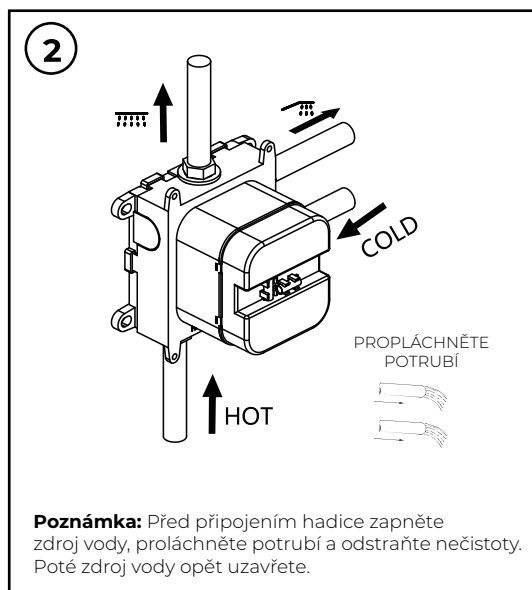
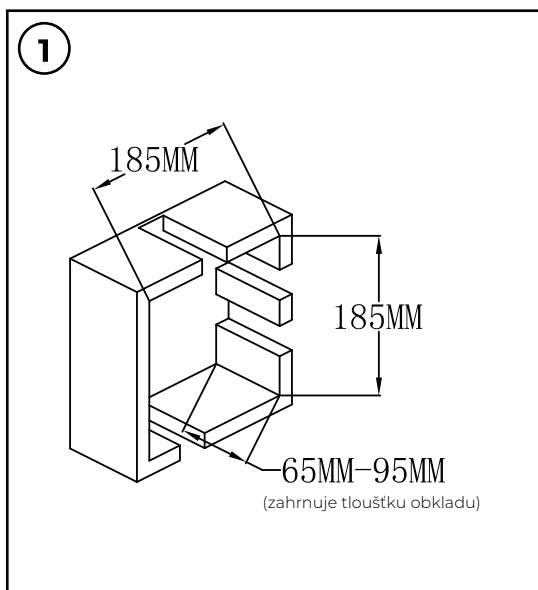

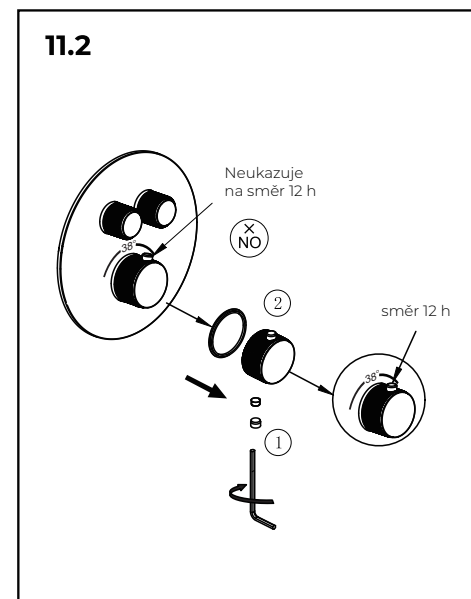
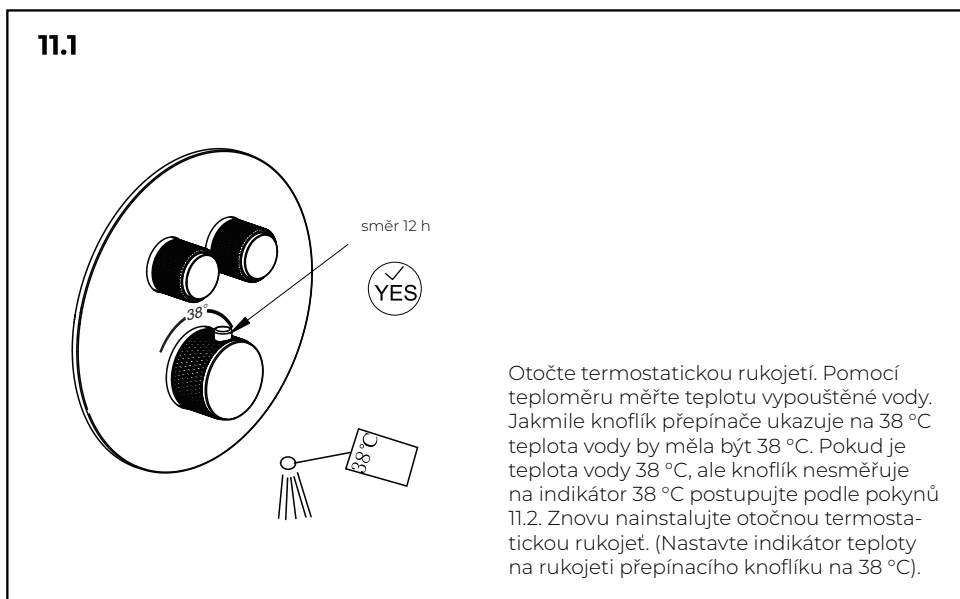
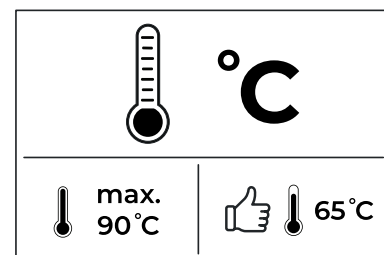
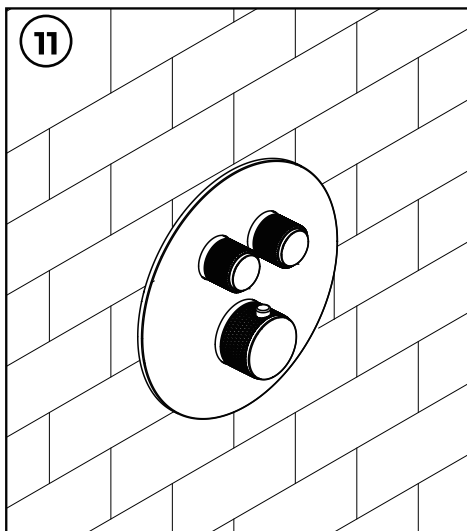
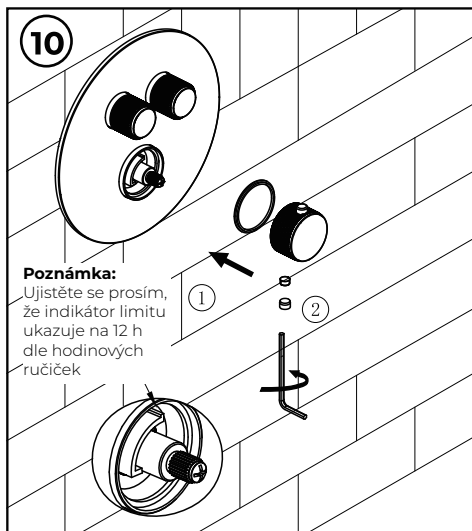
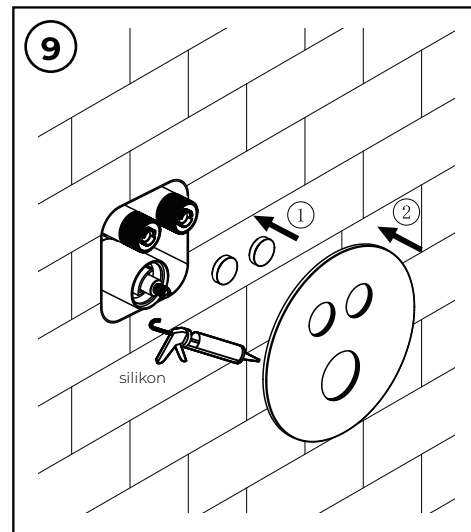
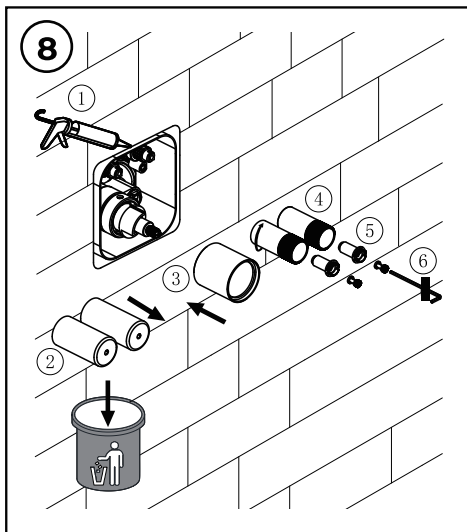
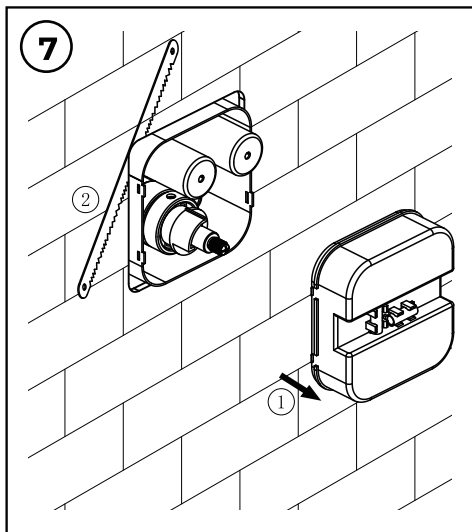

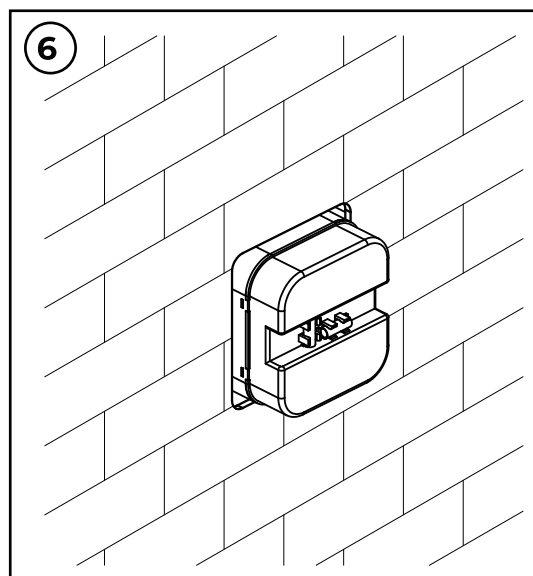
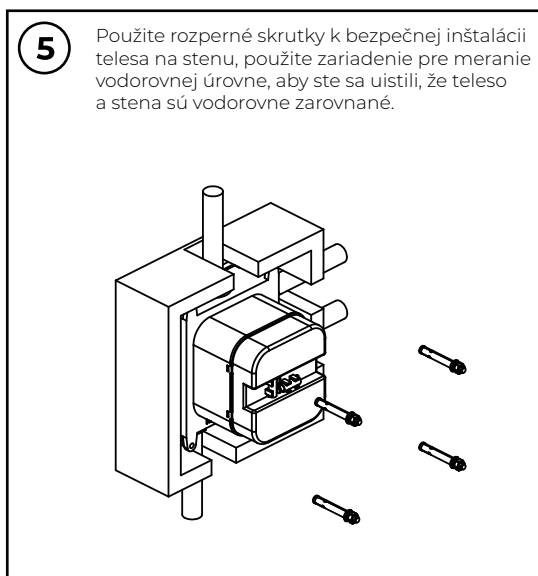
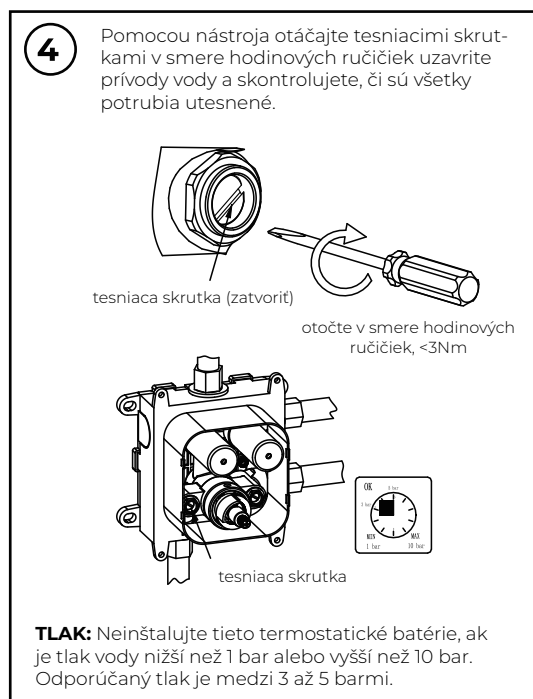
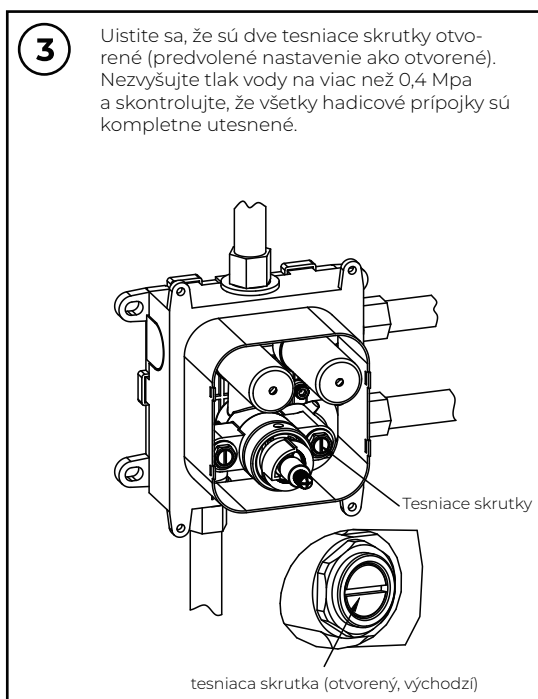
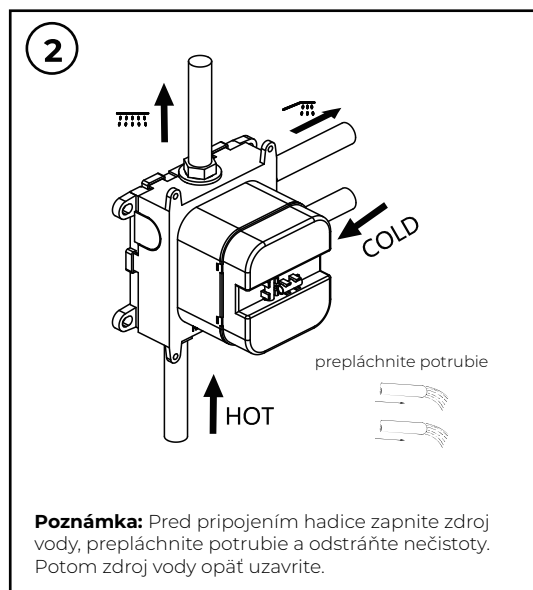
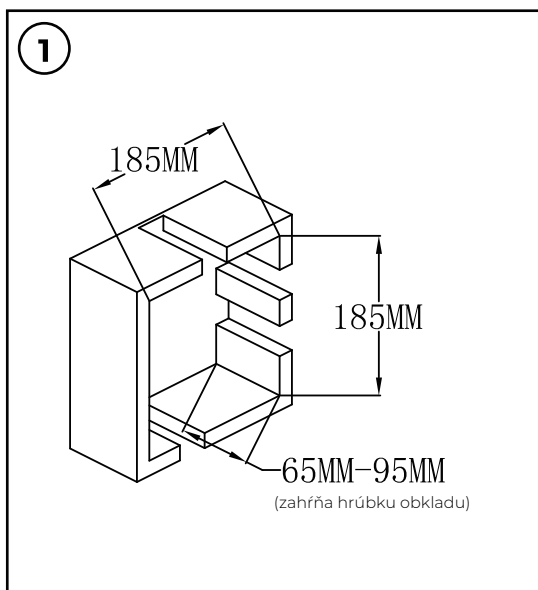

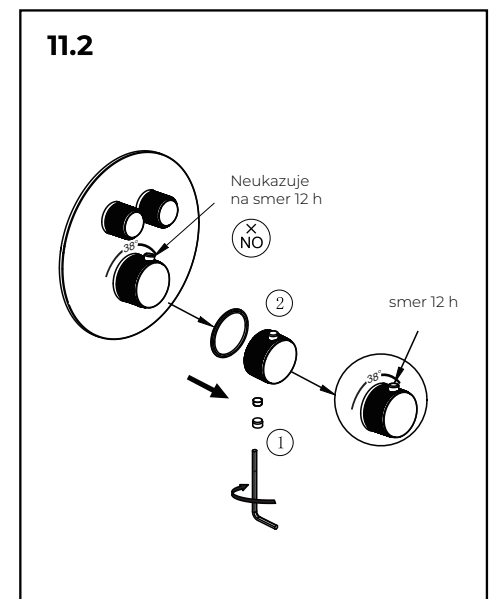
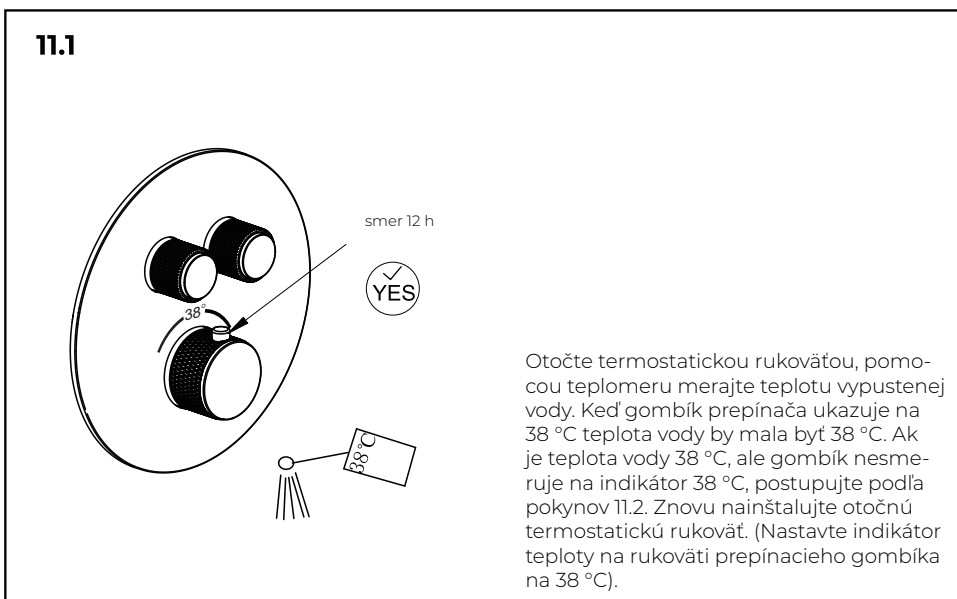
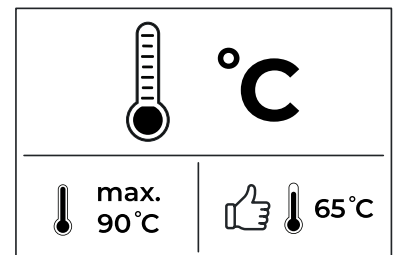
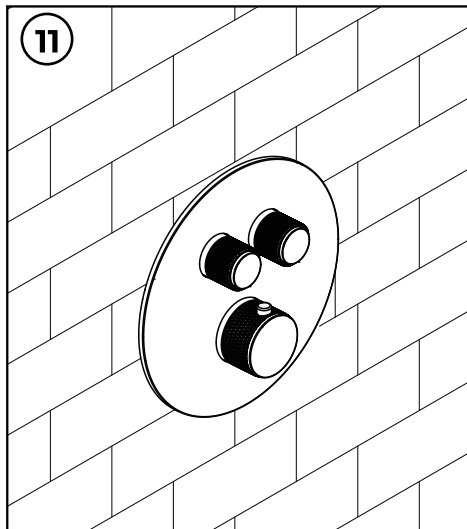
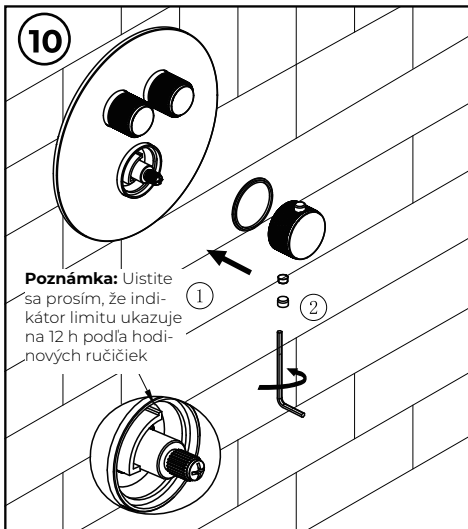
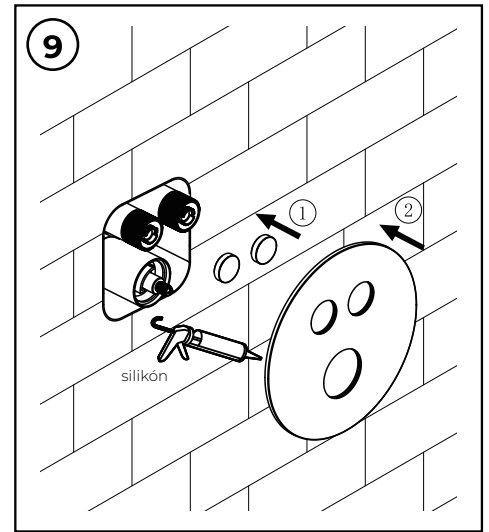
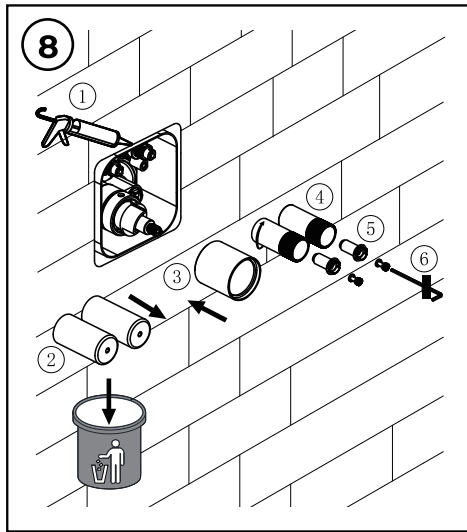
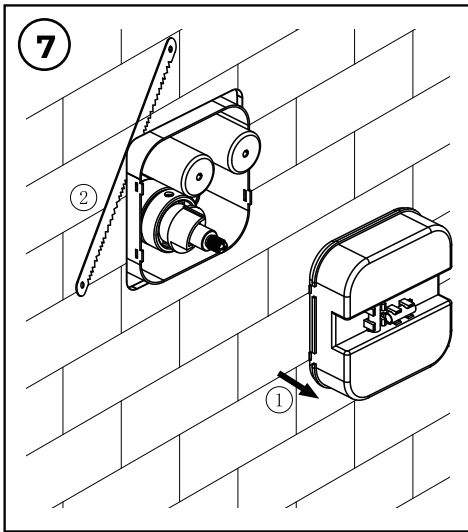

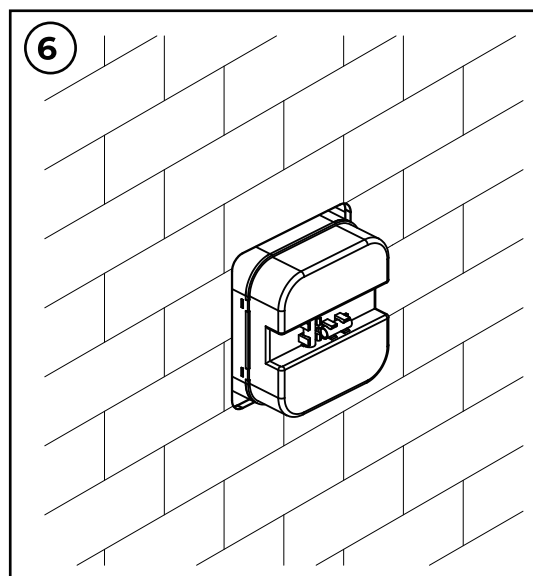
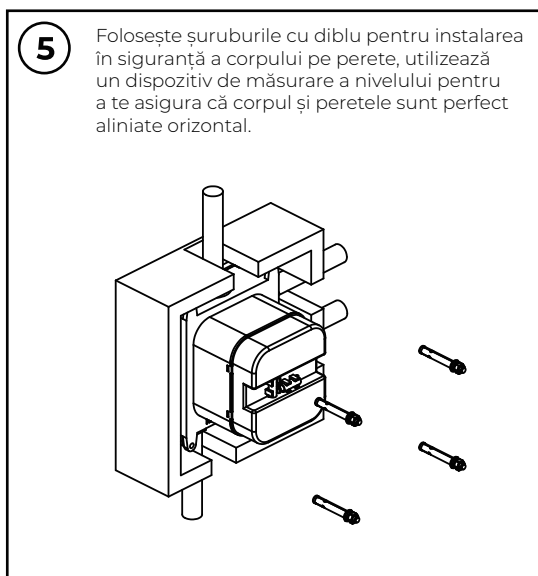
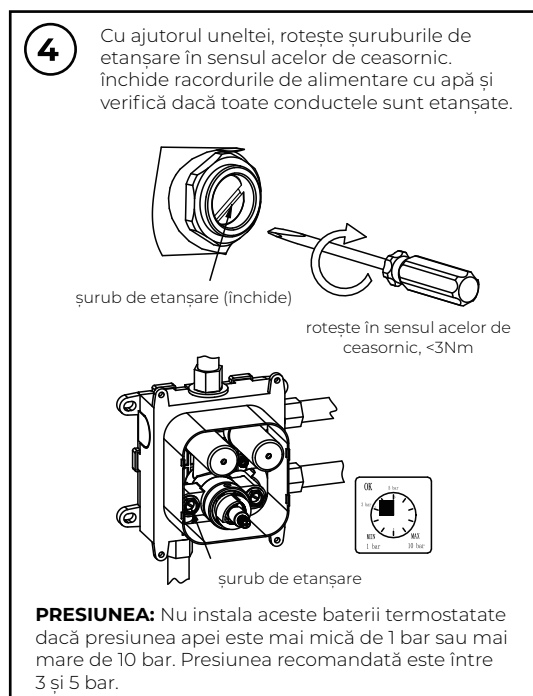
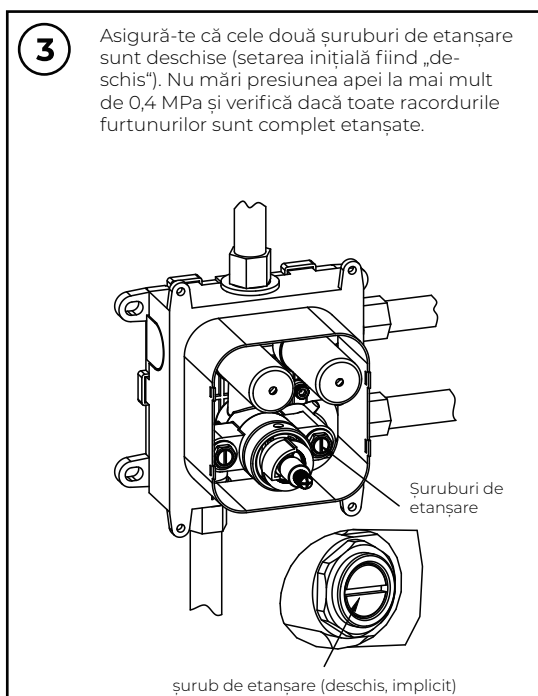
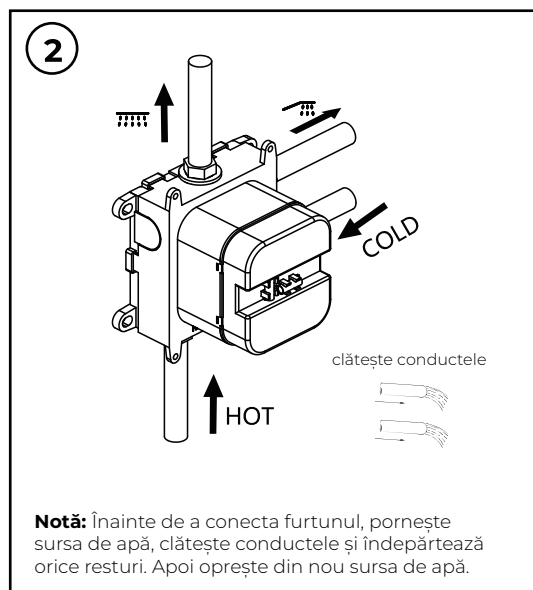
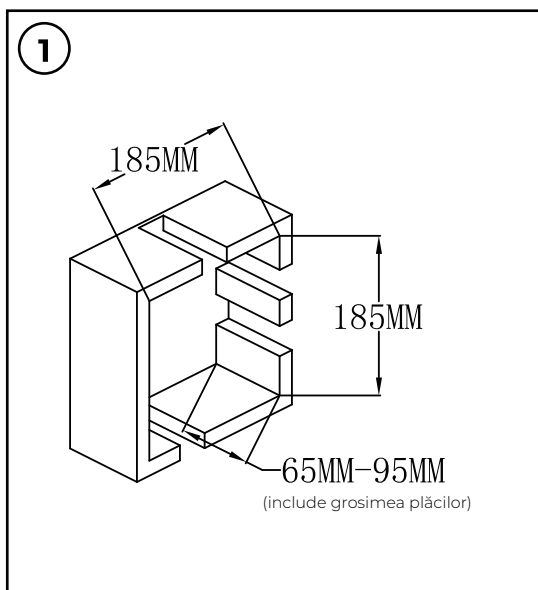

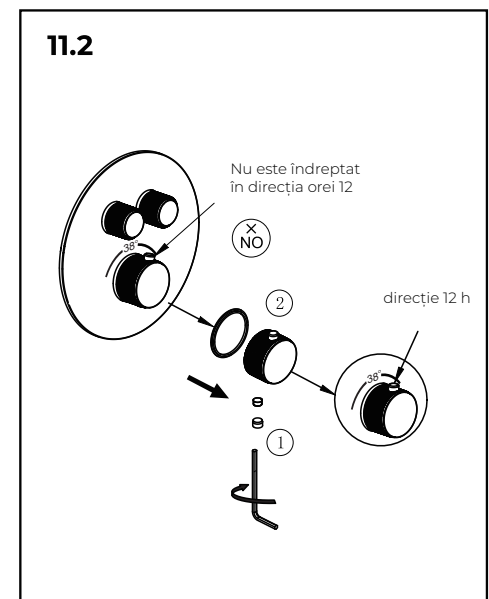
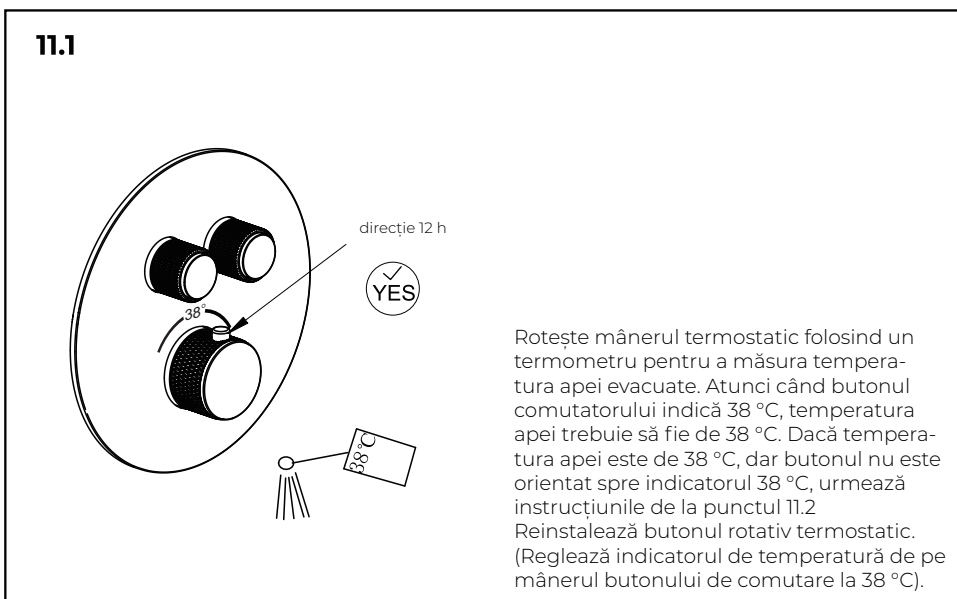
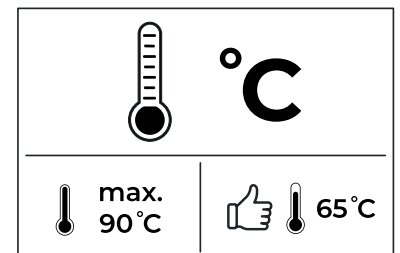
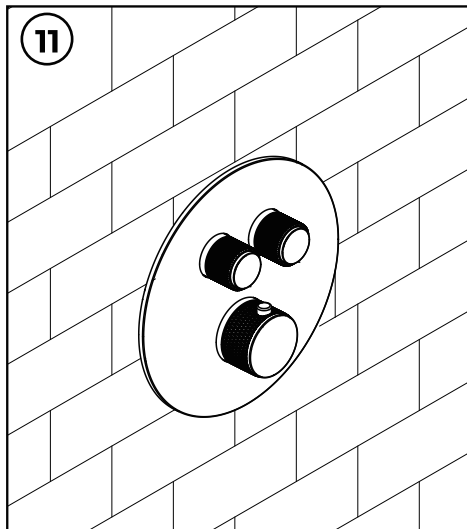
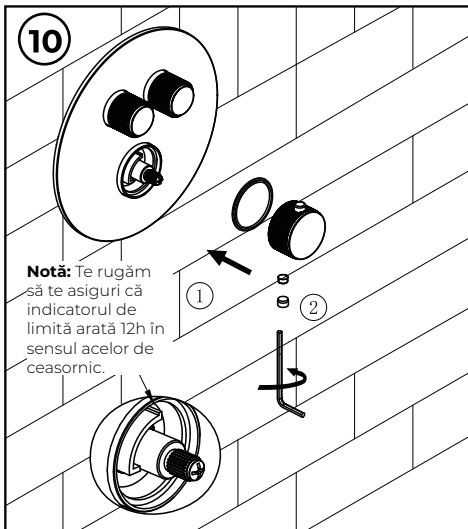
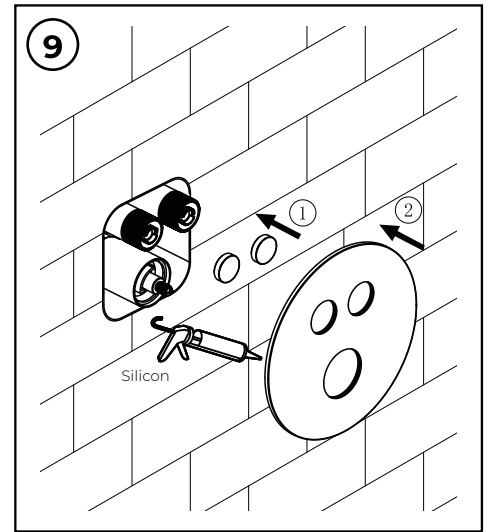
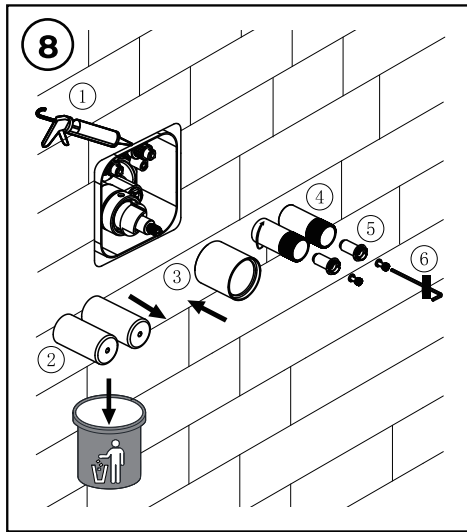
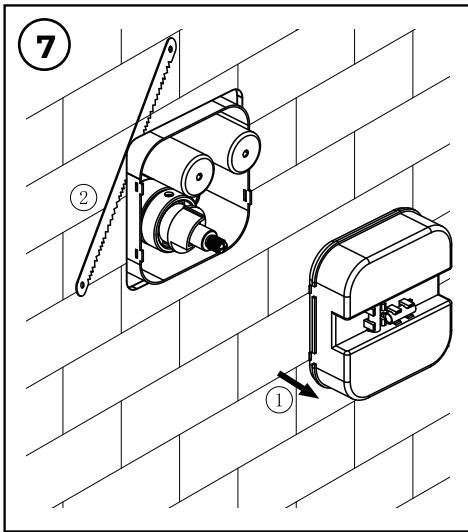

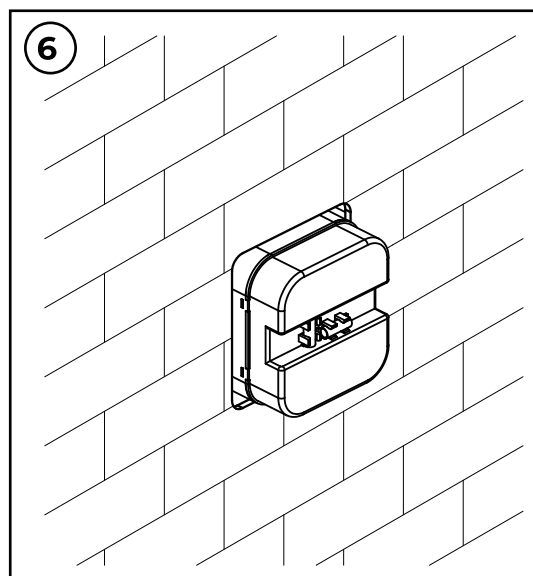
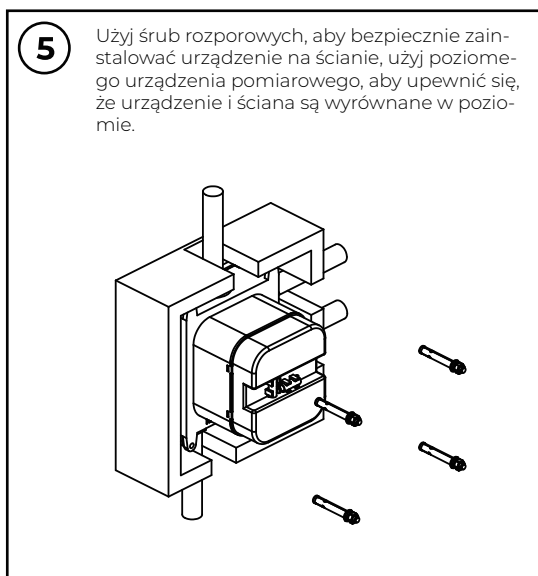
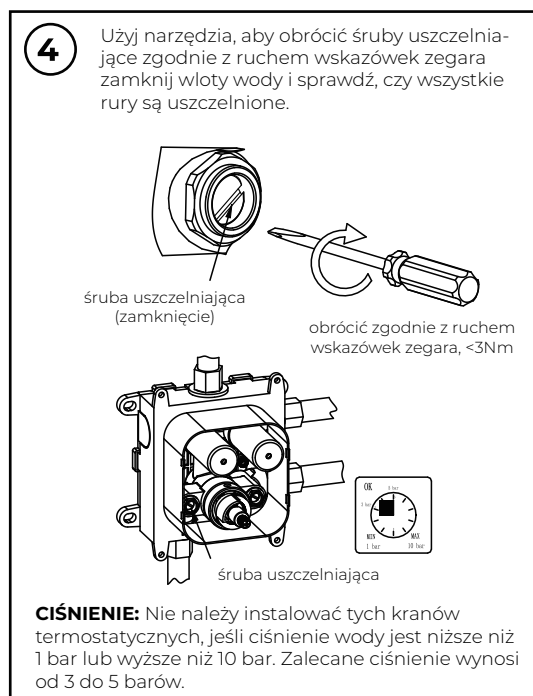
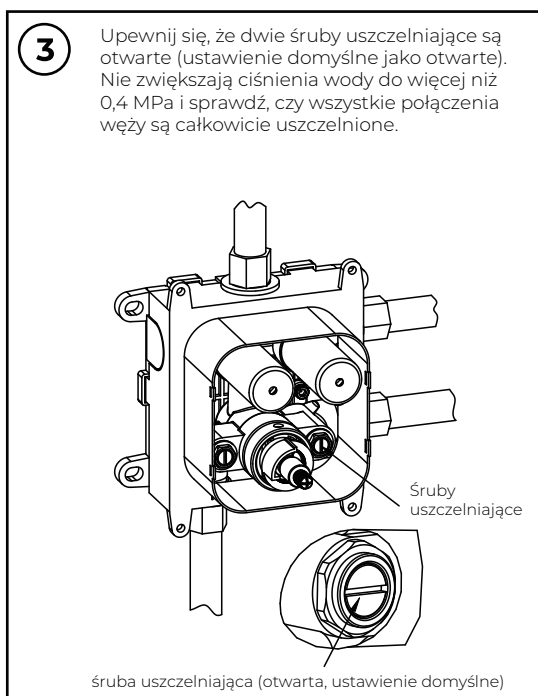
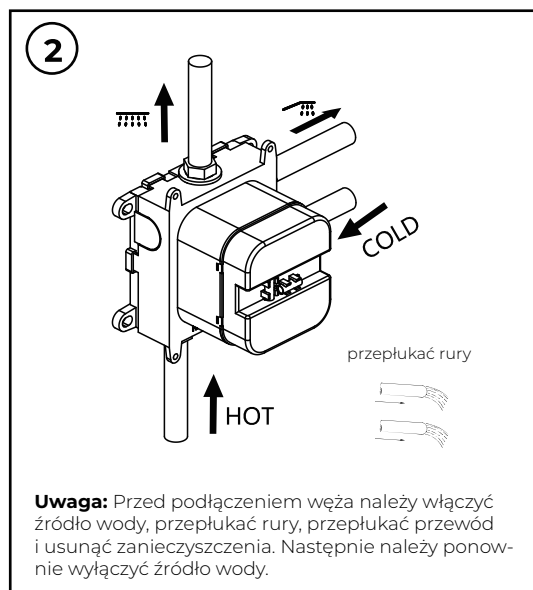
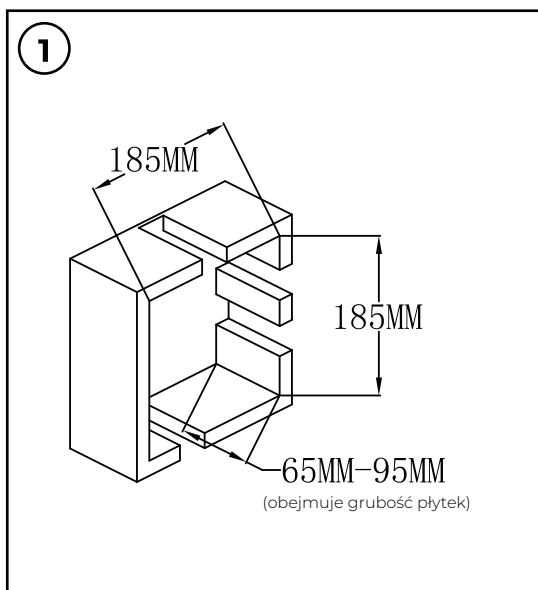

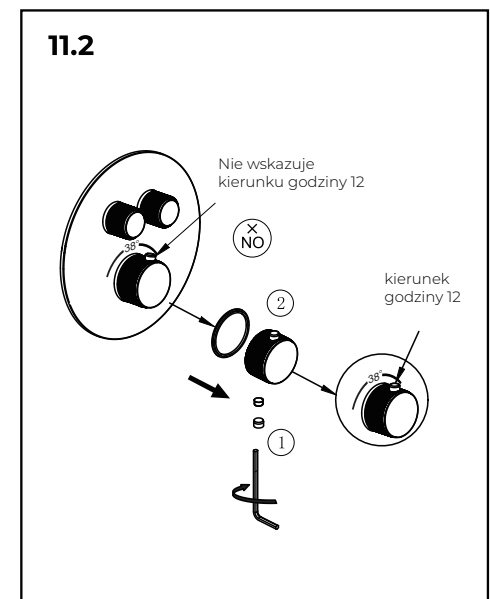
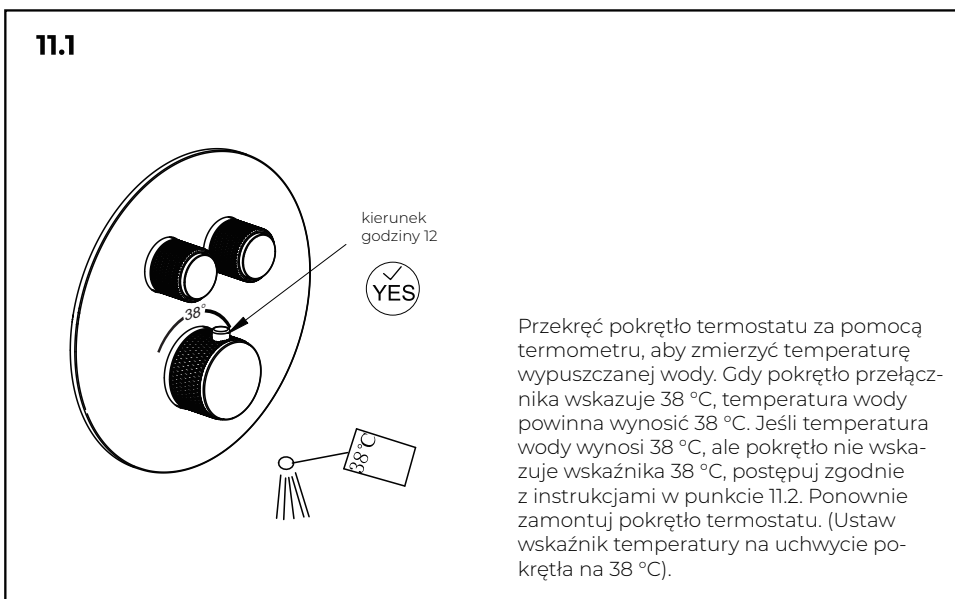
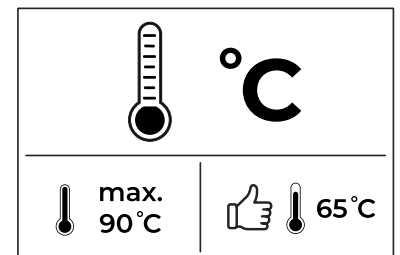
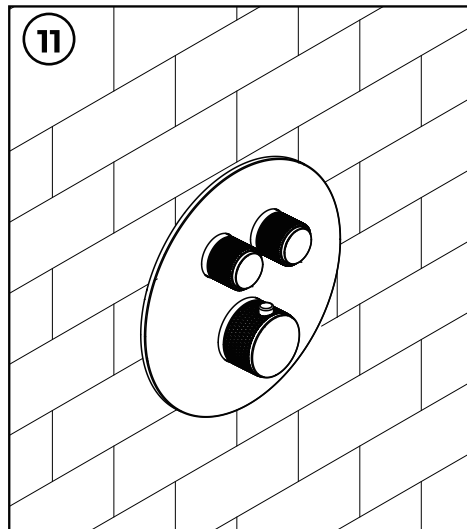
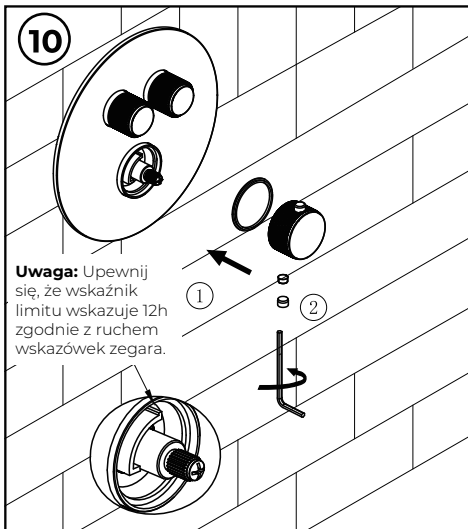
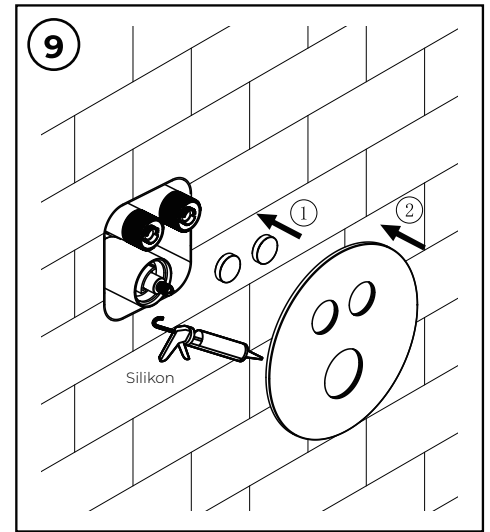
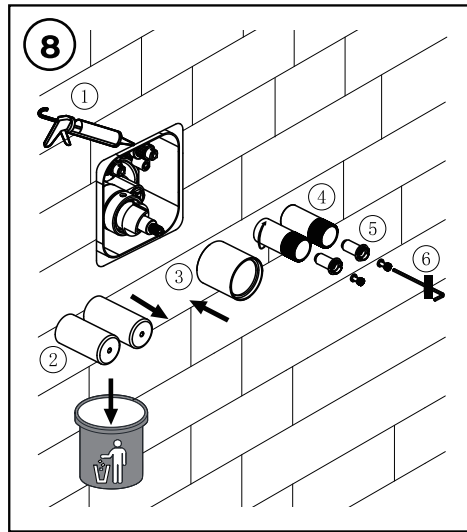
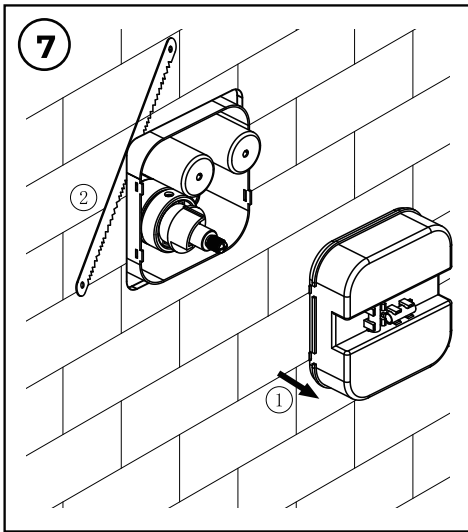

kielle

2.

3.

4.

1.

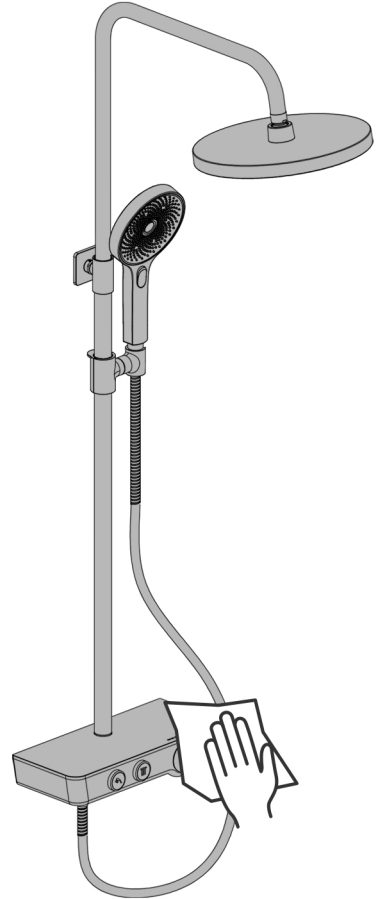
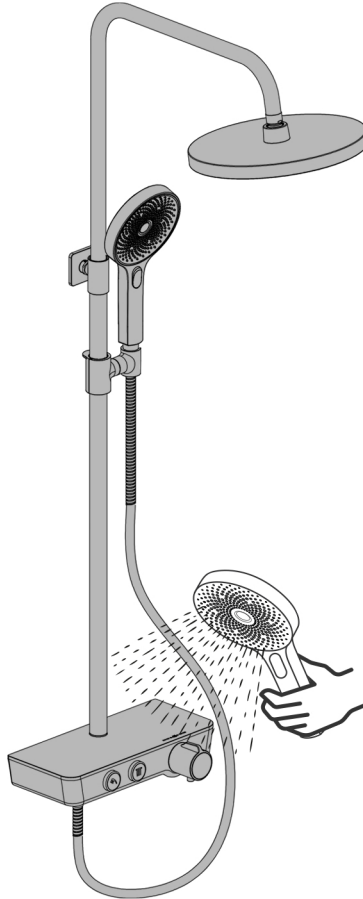
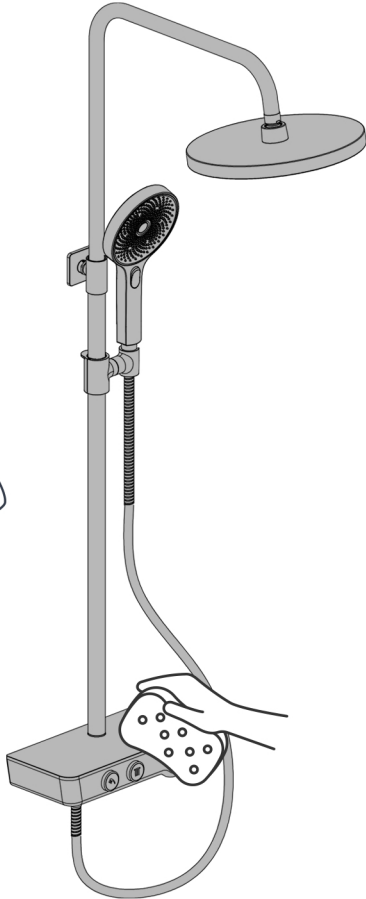

1.



2.

TIPS

